

26 High Street, Royal Wootton Bassett, Wiltshire SN4 7AA
Telephone SALES: 01793 840222 or LETTINGS 01793 855222
Email: sales@alanhawkins.co.uk or lettings@alanhawkins.co.uk

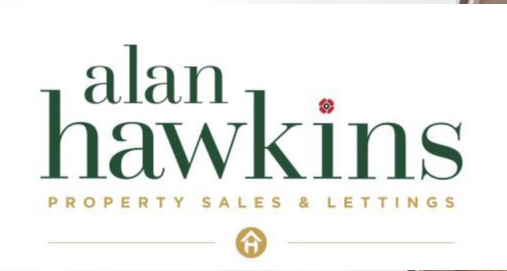

alanhawkins.co.uk

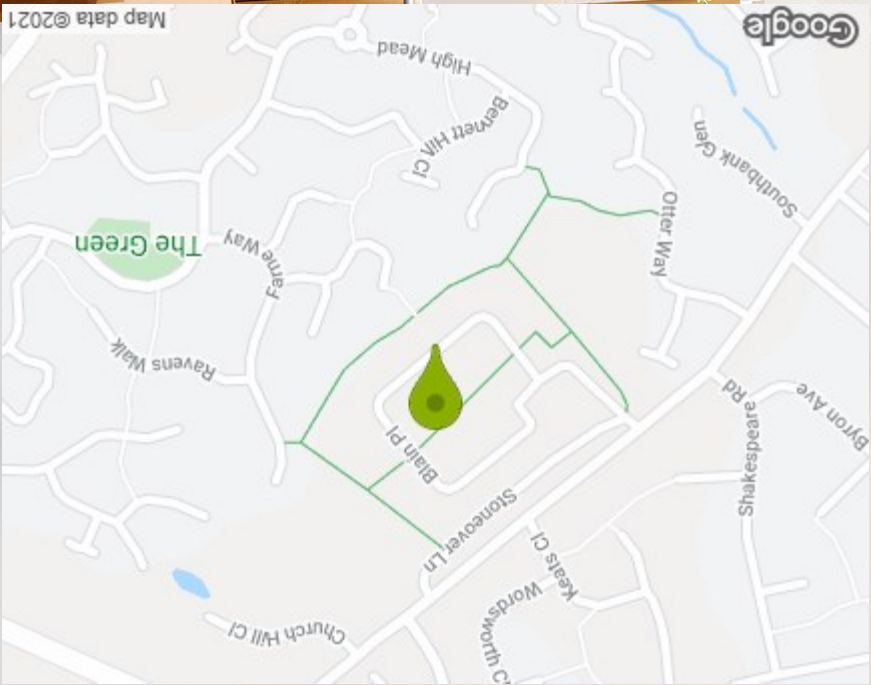

67 Blain Place, Royal Wootton Bassett, SN4 8FF

67 Blain Place, Royal Wootton Bassett, SN4 8FF

£260,000

A beautifully presented 2014 constructed double fronted 3 bedroom house favourably located on the fringe of this modern Taylor Wimpey development in Royal Wootton Bassett with open views to the front. Benefitting from off road parking for up to 3 CAR PARKING to the rear, this stunning property comprises a surprisingly spacious entrance hall with cupboard and cloakroom, a dual aspect kitchen/diner with integrated appliances and a dual aspect lounge with French Doors to the rear garden. To the first floor is a landing, three bedrooms and a family bathroom. The master enjoys built-in wardrobes and an-suite and again being dual aspect providing plenty of natural light. Further attributes include gas radiator central heating and the inclusion of curtains and blinds where fitted.

Council Tax - Wiltshire Council

For information on tax banding and rates, please call Wiltshire Council, Monkton Park. Chippenham. Wiltshire. SN15 1ER. Tel: 0300 456 0109

Viewings

Viewing: By appointment through Alan Hawkins Property Sales. Tel: 01793 840222

Tenure

Freehold

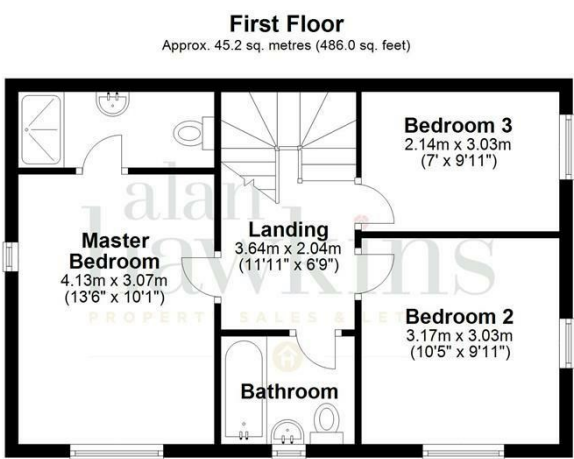

Total area: approx. 89.7 sq. metres (965.6 sq. feet)

All measurements of doors, windows, rooms and any other items are approximate and no responsibility is taken for any error, omissions or mis-statement. This plan is for illustrative purposes only and should be used as such. Not to scale. All Rights Reserved, no unauthorised use, copying or reproduction permitted.
Plan produced using PlanUp.

