



4 Walnut Tree Close, Wells , BA5 2NL

£1,000 Per Month

- Two Bedrooms
- Allocated parking
- Freshly Decorated
- Gas Central heating
- City of WELLS
- Quiet Cul-de-sac
- enclosed rear garden
- Double Glazed
- Mendip Band B

This attractive two-storey home offers far more than first impressions suggest and must be viewed internally to be fully appreciated. Situated in a quiet cul-de-sac within a sought-after residential area of Wells.

Accommodation comprises a spacious fitted kitchen, a comfortable lounge, two generous double bedrooms, and a family bathroom on the ground floor.

Additional benefits include gas central heating, double glazing, a private enclosed rear garden, and one allocated parking space.

The Property has been freshly decorated.

Wells, England's smallest Cathedral City, is nestled between the Somerset Levels and the Mendip Hills, offering an excellent balance of historic charm and modern convenience. The city provides a wide range of amenities including High Street shopping, a cinema, theatre, library, leisure centre, golf course,.

Residents can also enjoy a variety of restaurants, hotels, cafés, and traditional public houses. A market takes place in the city centre,

The cities of Bristol and Bath are both approximately 20 miles away, while nearby Castle Cary railway station provides direct mainline services to London Paddington.





GROUND FLOOR

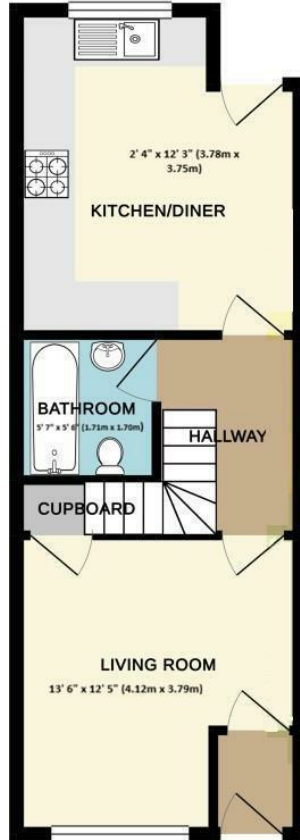

1ST FLOOR

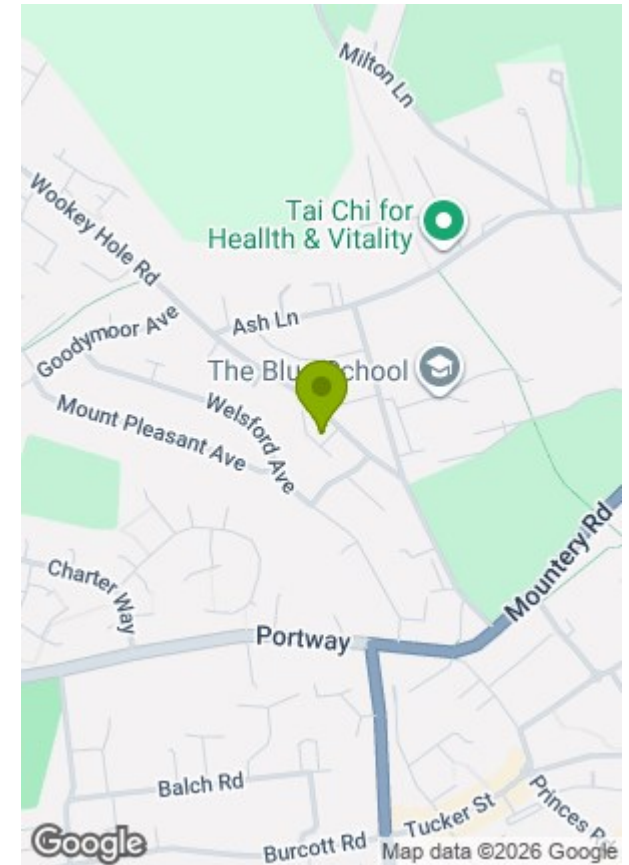
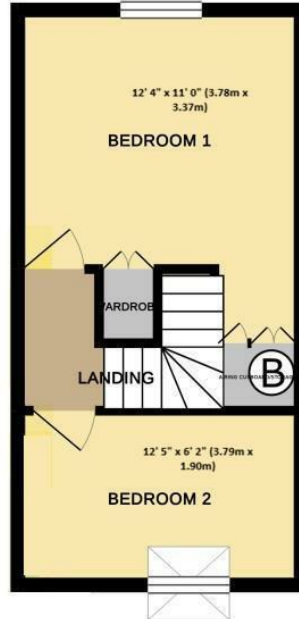

Whilst every attempt has been made to ensure the accuracy of the floorplan contained herein, measurements of doors, windows, rooms and any other items are approximate and no responsibility is taken for any error, omission or mis-statement. This plan is for illustrative purposes only and should be used as such by any prospective purchaser. The services, systems and appliances shown have not been tested and no guarantee as to their operability or efficiency can be given.
 Made with Metropix ©2023

Energy Efficiency Rating

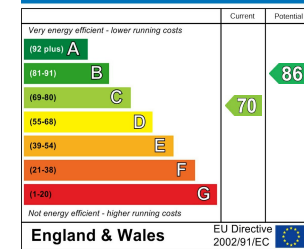

Environmental Impact (CO₂) Rating

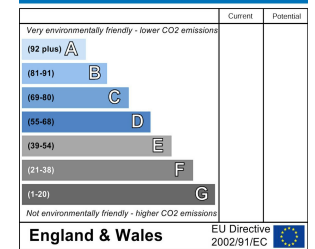

These particulars, whilst believed to be accurate are set out as a general outline only for guidance and do not constitute any part of an offer or contract. Intending purchasers should not rely on them as statements of representation of fact, but must satisfy themselves by inspection or otherwise as to their accuracy. No person in this firm's employment has the authority to make or give any representation or warranty in respect of the property.