



**The Old Maltings, Oakhill, Radstock , BA3 5BX**

**£240,000**

- Two Bedroom Terrace
- Enclosed Garden
- School & Pub Nearby
- Tenure - Freehold
- Council Tax Band - B
- Two Parking Spaces
- Ideal for First Time Buyers
- Quiet Cul-De-Sac
- Energy Rating - C

Barons are delighted to bring to the market The Old Maltings, Oakhill, Radstock, a charming two bedroom mid-terrace home offering an ideal blend of comfort and practicality.

Upon entering the property, you are welcomed by an inviting hallway leading to a well-appointed kitchen and a spacious living/dining room. This bright and versatile space is perfect for both relaxing evenings and entertaining guests.

Upstairs, the property boasts two well-proportioned double bedrooms, complemented by a modern family bathroom, providing comfortable accommodation throughout.

A particular highlight of this home is the private parking for two vehicles, a rare and highly desirable feature in this sought-after location, offering both convenience and peace of mind.

Situated within the picturesque setting of The Old Maltings, the property enjoys a strong sense of community while remaining within easy reach of local amenities and transport links. Further benefits include UPVC double glazing and gas central heating.

Whether you are a first-time buyer, downsizer, or investor seeking a rental opportunity, this delightful home is sure to impress. Early viewing is highly recommended to fully appreciate all it has to offer.

Kitchen 9'8" x 6'7" (2.95 x 2.01)

Living / Dining Room 13'5" x 12'9" (4.09 x 3.89)

Bedroom One 12'11" x 10'0" (3.94 x 3.05)

Bedroom Two 9'8" x 6'11" (2.95 x 2.11)

Bathroom





### The Old Maltings, Oakhill, Radstock, BA3

Approximate Area = 616 sq ft / 57.2 sq m  
For identification only - Not to scale

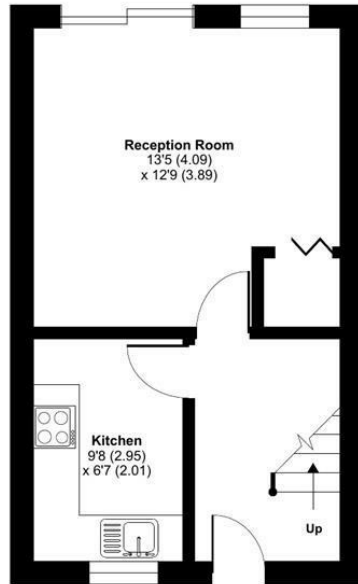

GROUND FLOOR

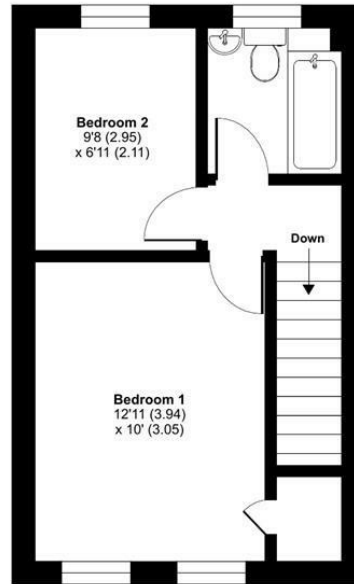

FIRST FLOOR

Floor plan produced in accordance with RICS Property Measurement Standards incorporating International Property Measurement Standards (IPMS2 Residential). © nichecom 2026. Produced for Barons Property Centre. REF: 1416381

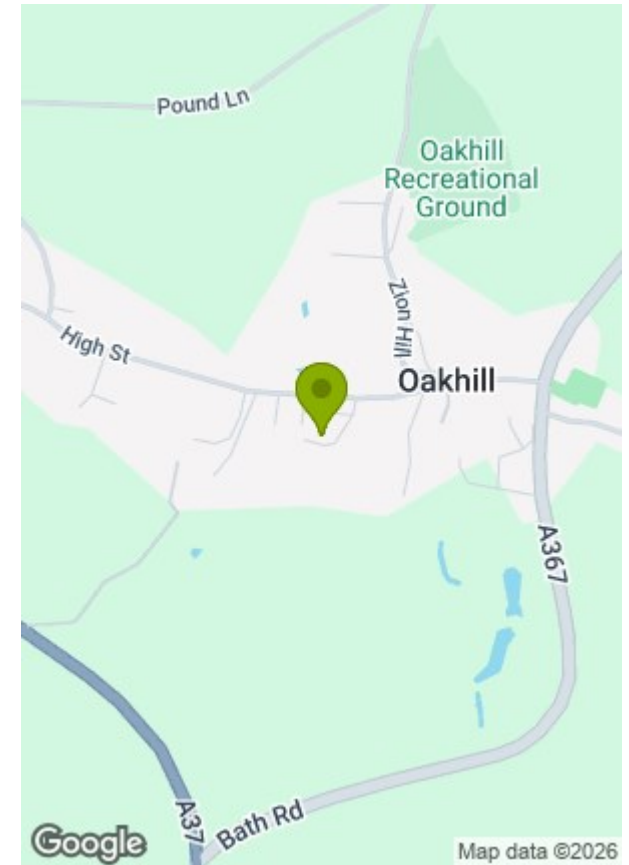

#### Energy Efficiency Rating

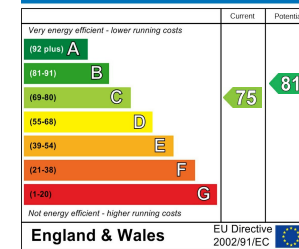

#### Environmental Impact (CO<sub>2</sub>) Rating

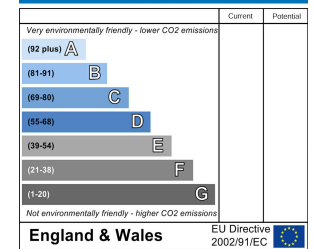

These particulars, whilst believed to be accurate are set out as a general outline only for guidance and do not constitute any part of an offer or contract. Intending purchasers should not rely on them as statements of representation of fact, but must satisfy themselves by inspection or otherwise as to their accuracy. No person in this firm's employment has the authority to make or give any representation or warranty in respect of the property.