



1 Dunnabridge Square

Dorchester, DT1 3TG

£1,280 PCM



AVAILABLE TO LET, this TWO BEDROOM apartment, offers a STYLISH and SPACIOUS layout. The property benefits from a PRIVATE SUNNY COURTYARD and LARGE CARPORT, situated within THE HEART OF POUNDBURY.

Your private front door opens on to a generous open plan living/ dining space, this ample space is perfect for entertaining or relaxing with friends and family. Door opens onto the kitchen which is fully fitted with integrated fringe freezer, oven with hot plate draw, hob with extractor fan and plentiful fitted cupboards.

Hallway leads you through to the rest of the property. The bathroom is a spacious fitted white suite with large freestanding bath, fitted units with sink featuring a waterfall style tap, low level WC and cabinets. A large storage cupboard leads off the hallway, which provides ample space for all your storage needs. The hallway continues to bedroom one, a spacious double bedroom with large window to the front providing a light airy feel, this room offers ample space for wardrobes. Bedroom two offers versatility as a single room, nursery or home office with extra added fitted wardrobes, a window looks out onto the courtyard patio.

Externally this property boasts a private courtyard seating area, a lovely suntrap and perfect area to enjoy the summer rays, you can also find a outside tap. Additionally this property has a large carport, which has netting fitted to avoid pigeon nesting. There is also electric to the carport. The property itself is located within close proximity to walks/fields with local shops, schools and amenities nearby.

Further benefits of this property include bespoke fitted shutters throughout that are included with the sale of the property. A private storage cupboard in the communal entrance hall, providing extra storage space to the property and perfect place for excess storage or outside equipment.

Area Map



Energy Efficiency Graph

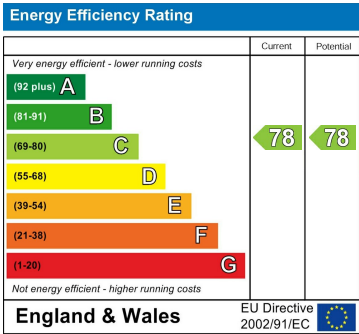

Floor Plans

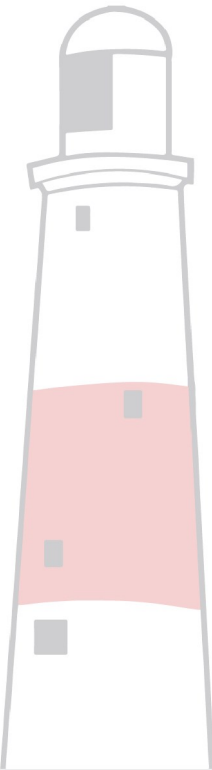
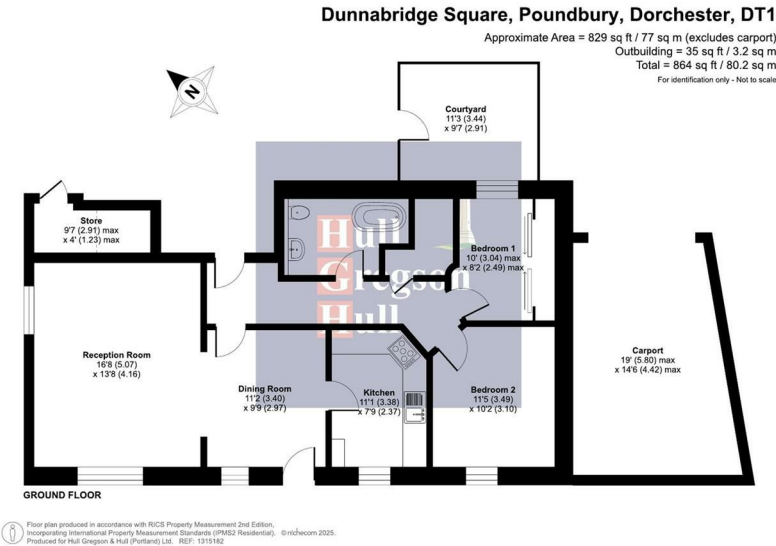

These particulars, whilst believed to be accurate are set out as a general outline only for guidance and do not constitute any part of an offer or contract. Intending purchasers should not rely on them as statements of representation of fact, but must satisfy themselves by inspection or otherwise as to their accuracy. No person in this firms employment has the authority to make or give any representation or warranty in respect of the property.

12 Easton Street, Portland, Dorset DT5 1BT