

Easton Square

Portland, DT5 1BX



Guide Price
£225,000 Freehold



Easton Square

Portland, DT5 1BX

- Three Bedroom Character Cottage
- Conveniently Positioned on Easton Square
- Two Reception Rooms
- Ample Character Features
- Recently Installed Combination Boiler
- Bay Windows
- Low Maintenance Garden
- No Forward Chain
- Stone Built Outbuilding
- Accommodation Arranged Over Three Floors





Overlooking Easton Gardens is this **CHARMING CHARACTER COTTAGE** with **THREE BEDROOMS**, **TWO RECEPTION ROOMS** AND A **WESTERLY GARDEN**, situated on Easton Square. The property enjoys an array of **CHARACTER FEATURES** to include ornate fireplaces, stained glass door and bay windows, adding to the cottage feel.

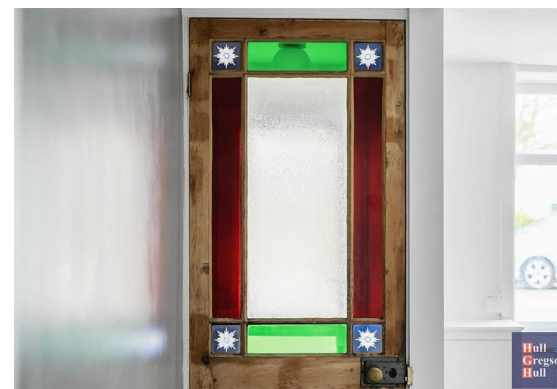

Entering over the threshold, you find yourself in the entrance porch. From the entrance hallway - which provides access through to all ground floor accommodation - you find yourself in the front aspect sitting room. The room is well-proportioned and boasts an ornate fireplace and deep set bay



window to the front. The space is well-presented and would make the perfect space to entertain guests or relax with family of an evening.

Adjacent to the Sitting Room, you find yourself in the well proportioned Dining Room which leads into the kitchen and enjoys a further feature fireplace and deep set sash window. The room presents as a beautiful space to enjoy meals, a morning coffee or to catch up on a few work emails.

To the rear of the ground floor accommodation, you find yourself in the Kitchen. The Kitchen is well-presented, light and airy and boasts ample space for appliances. The kitchen comprises cream kitchen cabinets with wood effect worktops, integrated oven, inset electric hob, stainless steel sink and space for appliances.



The first floor comprises of two bedrooms and the family bathroom. Bedroom one has a pleasant outlook over Easton Gardens through a large bay window and enjoys ample storage surrounding a feature fireplace. Bedroom two, which lends itself to being a nursery or study, overlooks the rear garden. Bedroom three is well-proportioned room on the second floor and boasts plenty of space for a double bed and other furnishings

To the rear is a cottage style garden, mostly laid to shingle with an area of raised lawn. The garden is wall enclosed and boasts a stone built outhouse.

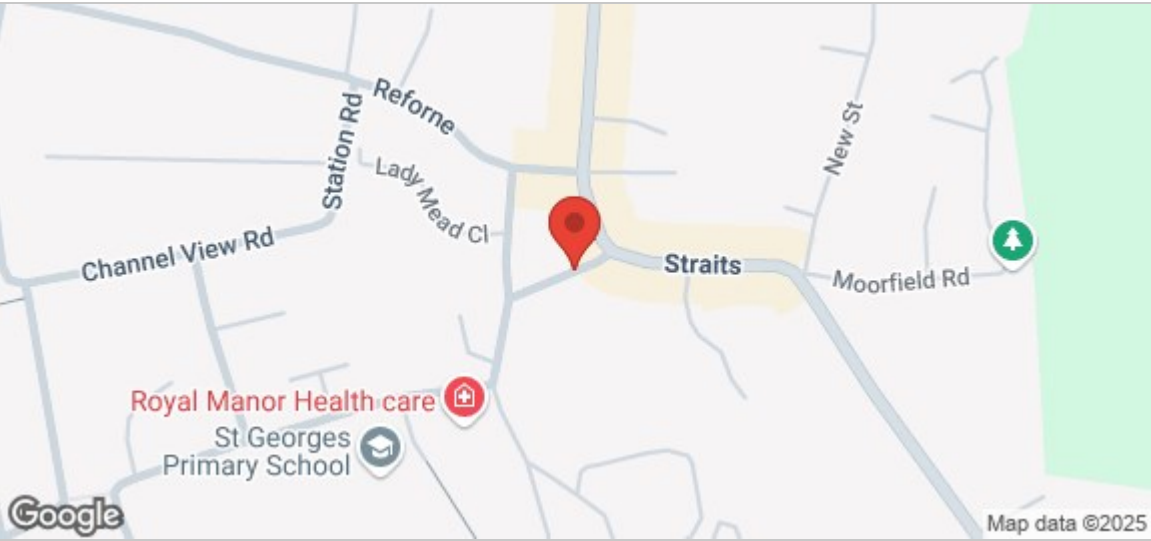
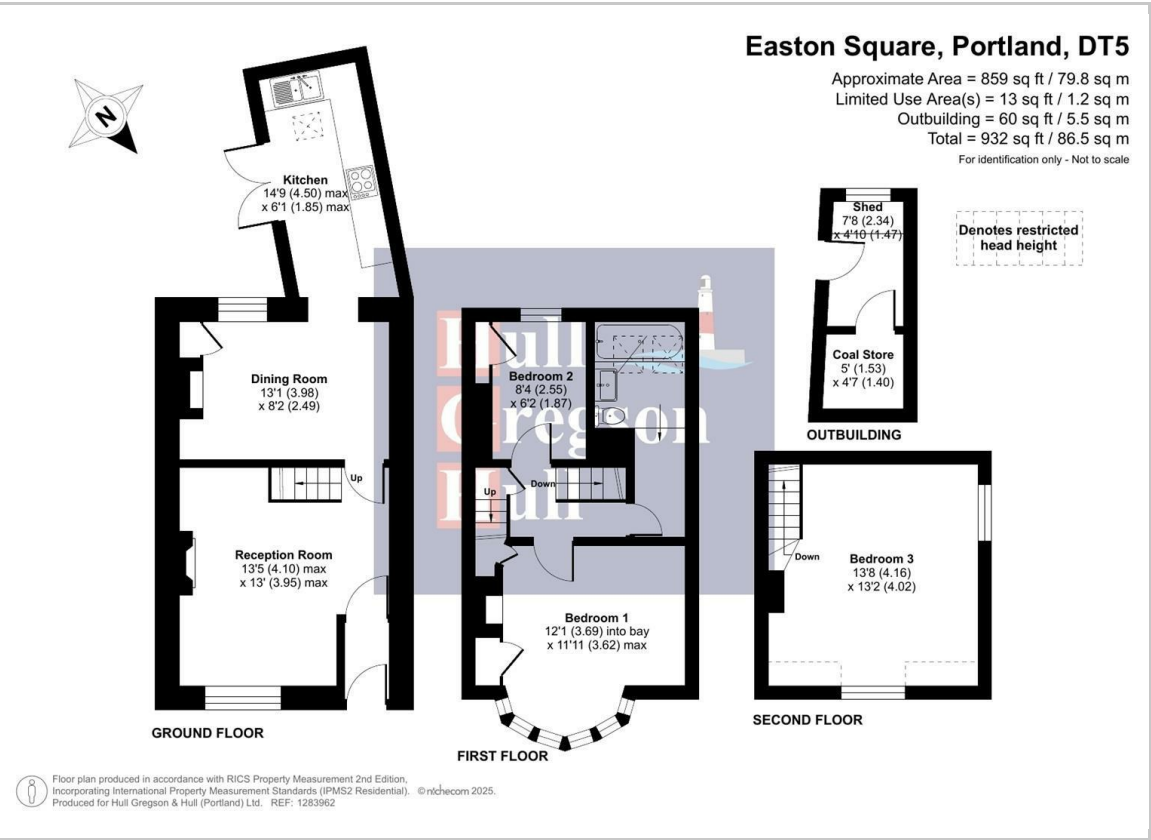

Living Room
12'11 x 13'5 (3.94m x 4.09m)

Dining Room
12'11 x 8' (3.94m x 2.44m)

Kitchen
6' x 14' (1.83m x 4.27m)

Bedroom One
12'1 x 8'11 (3.68m x 2.72m)

Bedroom Two
13'7 x 13'2 (4.14m x 4.01m)

Bedroom Three
6'1 x 8'5 (1.85m x 2.57m)

Additional information

The following details have been provided by the vendor, as required by Trading Standards. These details should be checked by your legal representative for accuracy.

Property type: End Terraced
Property construction: Standard Construction
Mains Electricity
Mains Water & Sewage: Supplied by Wessex Water
Heating Type: Gas
Broadband/Mobile signal/coverage: For further details please see the Ofcom Mobile Signal & Broadband checker.
checker.ofcom.org.uk/

Disclaimer

These particulars, whilst believed to be accurate are set out as a general outline only for guidance and do not constitute any part of an offer or contract. Intending purchasers should not rely on them as statements of representation of fact, but must satisfy themselves by inspection or otherwise as to their accuracy. All measurements are approximate. Any details including (but not limited to): lease details, service charges, ground rents, property construction, services, & covenant information are provided by the vendor and you should consult with your legal advisor/ satisfy yourself before proceeding. No person in this firms employment has the authority to make or give any representation or warranty in respect of the property.

