



**Panorama Road**

**Swanage, BH19 2QT**



**Asking Price**  
**£25,000 Commonhold**





## Panorama Road

Swanage, BH19 2QT

- Modern Caravan
- Picturesque Sea Views
- Two Bedrooms
- Modern Shower Room
- Open Plan Living Space
- Modern Fitted Kitchen
- Parking
- Family Friendly Holiday Park
- On-Site Facilities
- Seaside and Town Nearby







Nestled in the sought after holiday home park of Swanage Bay View, this charming two-bedroom caravan offers a delightful retreat in the Dorset seaside town of Swanage. The property is presented in modern condition, ensuring a comfortable and inviting atmosphere for its visitors.



The property comprises an open plan kitchen/living/diner with the living area comprising a feature fireplace for those cosy nights in. The kitchen comprises a range of wall and base level units with a built in oven, grill and four ring gas hob. There ample space for an



undercounter fridge with freezer tray and space for a microwave. The property has two large sofas and a fold away table and chairs.

There are two bedrooms, with the main bedroom including fitted wardrobes and bedside cabinets. The second bedroom is currently configured with twin beds and includes a built in wardrobe. Completing the accommodation is a modern fitted shower room comprising a shower cubicle, W.C. and pedestal wash hand basin.

One of the standout features of this lovely home is the allocated parking space, providing convenience for you and your guests. The sizeable decking area is perfect for enjoying the stunning views towards the Purbeck Hills and the sparkling sea, making it an ideal spot for relaxation or entertaining friends and family.

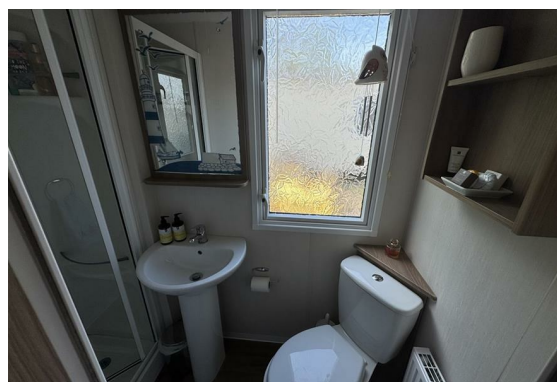

This property not only boasts a prime location but also offers a wonderful opportunity to immerse yourself in the natural beauty of Swanage. Whether you are seeking a longer stay or weekend retreat, this caravan is sure to impress with its blend of comfort and scenic surroundings. The site itself includes a bar, gym, swimming pool and restaurant.

Don't miss the chance to make this delightful property your own.

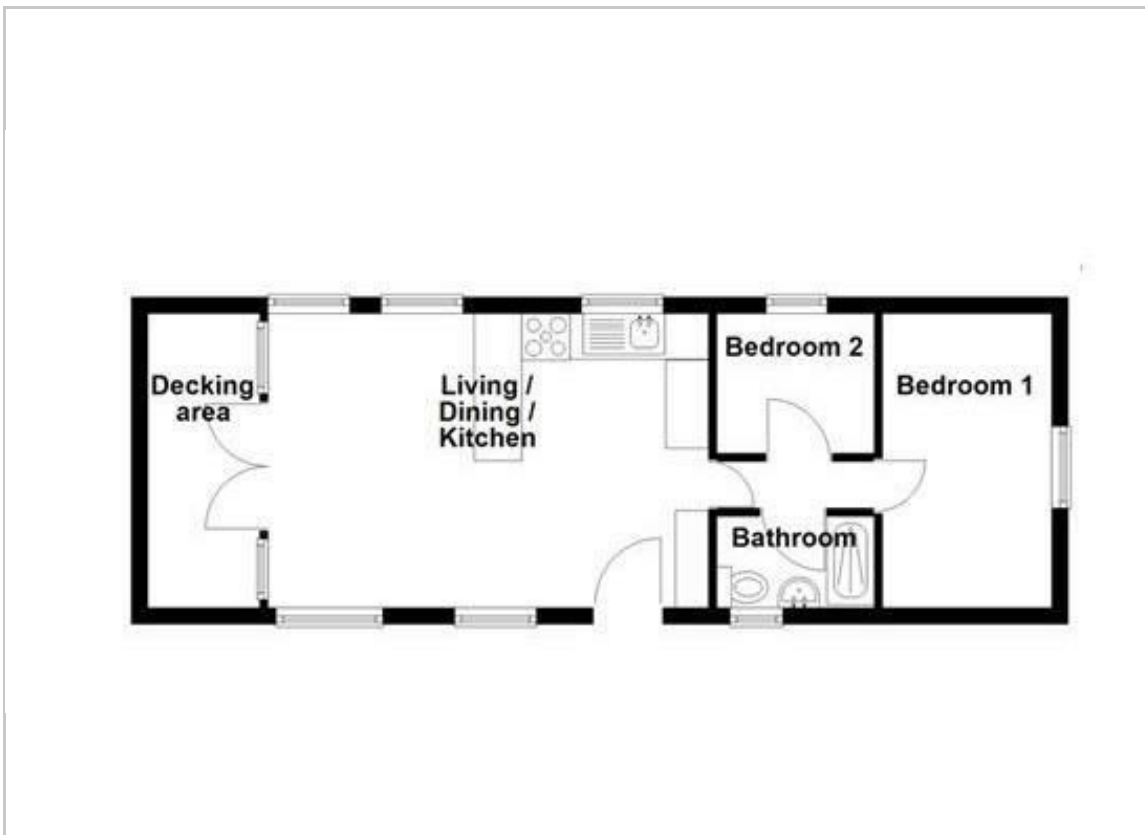

### **Living / Kitchen / Dining**

17'8" x 11'9" (5.39 x 3.60)

### **Bedroom One**

9'9" x 6'7" (2.99 x 2.01)

### **Bedroom Two**

6'3" x 5'7" (1.93 x 1.71)

### **Shower room**

6'7" x 2'11" (2.01 x 0.900)

### **Additional Information.**

The following details have been provided by the vendor, as required by Trading Standards. These details should be checked by your legal representative for accuracy.

Property type: Static Caravan

Tenure: The caravan was new in 2015 and holds a license with Bay Resorts at Swanage Bay View until 2031. The annual site fees are approximately £7058 (based on 2024 total).

Property construction: Standard.

Mains Electricity

Mains Water & Sewage: Supplied by Wessex Water

Heating Type: Bottled Gas

Broadband/Mobile signal/coverage: For further details please see the Ofcom Mobile Signal & Broadband checker. [checker.ofcom.org.uk/](https://checker.ofcom.org.uk/)

### **Disclaimer.**

These particulars, whilst believed to be accurate are set out as a general outline only for guidance and do not constitute any part of an offer or contract. Intending purchasers should not rely on them as statements of representation of fact but must satisfy themselves by inspection or otherwise as to their accuracy. All measurements are approximate. Any details including (but not limited to): lease details, service charges, ground rents, property construction, services, & covenant information are provided by the vendor, and you should consult with your legal advisor/ satisfy yourself before proceeding. No person in this firm's employment has the authority to make or give any representation or warranty in respect of the property.

