

BROTHERS

PROPERTY MANAGEMENT

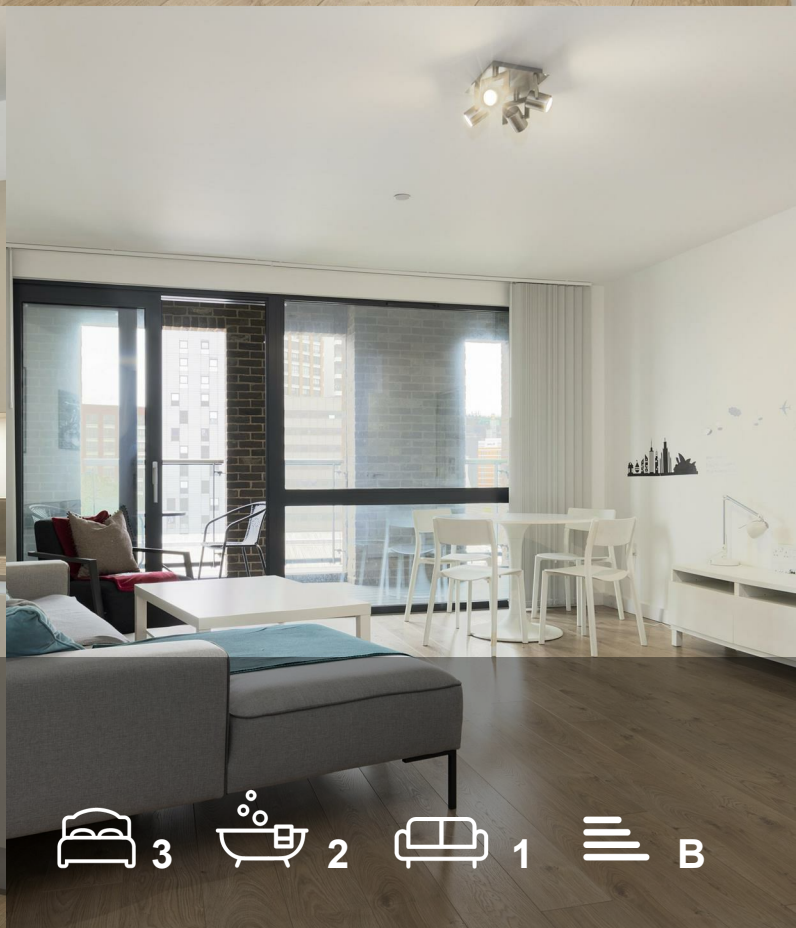
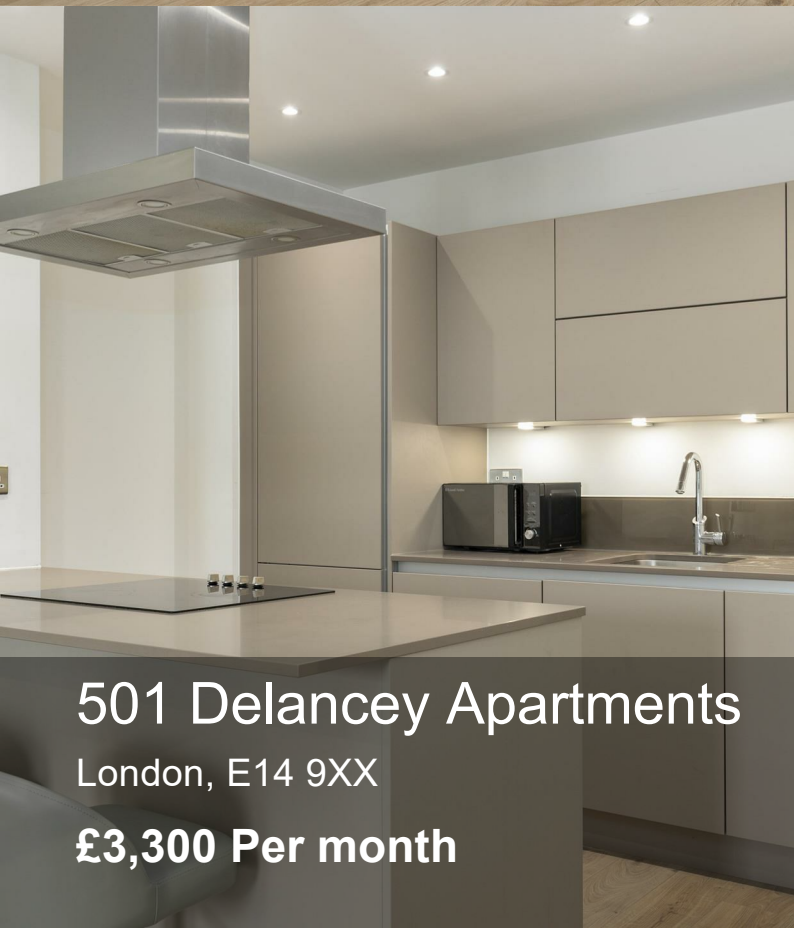

501 Delancey Apartments

London, E14 9XX

£3,300 Per month



Floor Plan

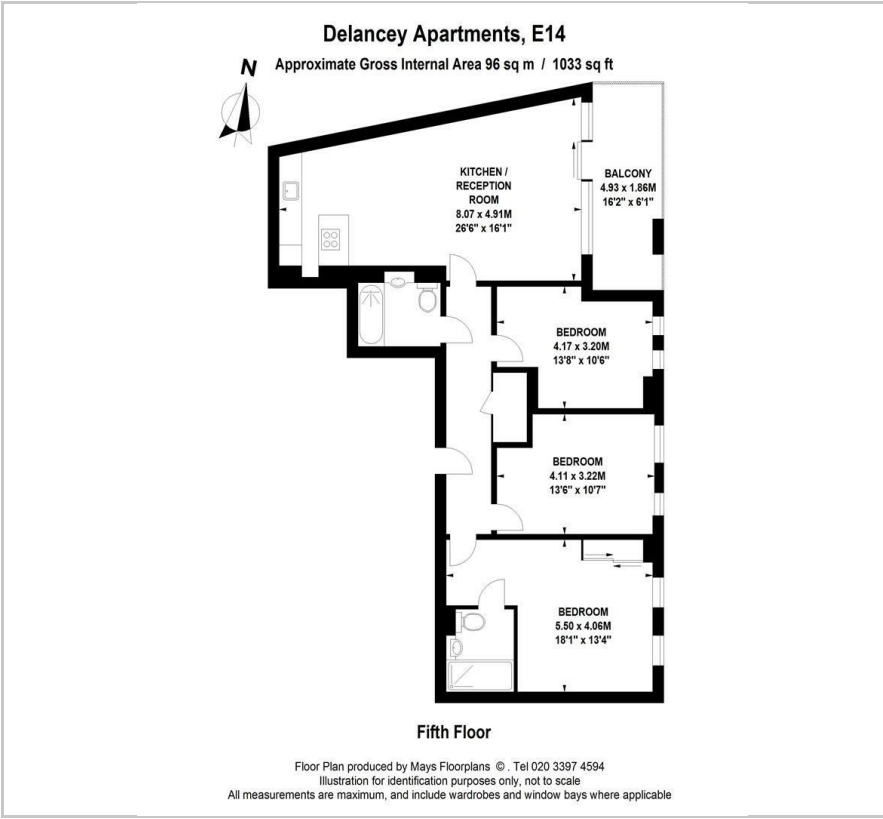

Area Map

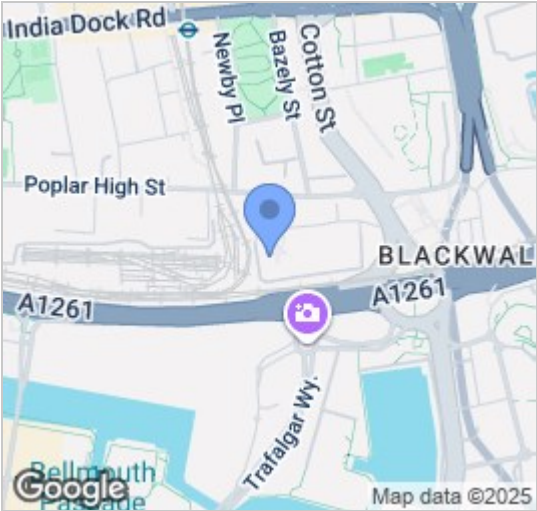

Energy Efficiency Graph

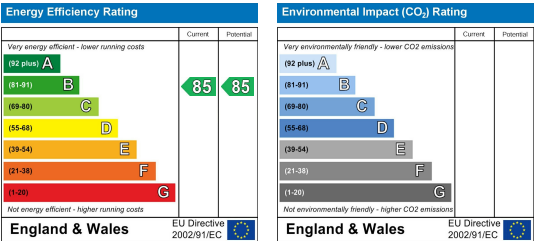

Viewing

Please contact our Brothers Property Management Office on 020 4526 6150 if you wish to arrange a viewing appointment for this property or require further information.

- Convenient Location
- Private Balcony
- Modern Furniture
- 20 Minutes Walk to Canary Wharf
- 1000+ Sq Ft
- Residents Gym
- Three Large Double Bedrooms
- 24 Hour Concierge
- 20 Minutes Train to Bank
- Parking Available by Separate Negotiation

A high specification, new build 5th floor apartment in the conveniently located Manhattan Plaza development.



These particulars, whilst believed to be accurate are set out as a general outline only for guidance and do not constitute any part of an offer or contract. Intending purchasers should not rely on them as statements of representation of fact, but must satisfy themselves by inspection or otherwise as to their accuracy. No person in this firms employment has the authority to make or give any representation or warranty in respect of the property.