

# BROTHERS

PROPERTY MANAGEMENT

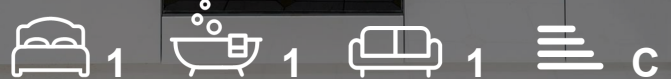

22 Royal Tower Lodge  
London, E1 8LX  
£1,950 Per month



## Floor Plan

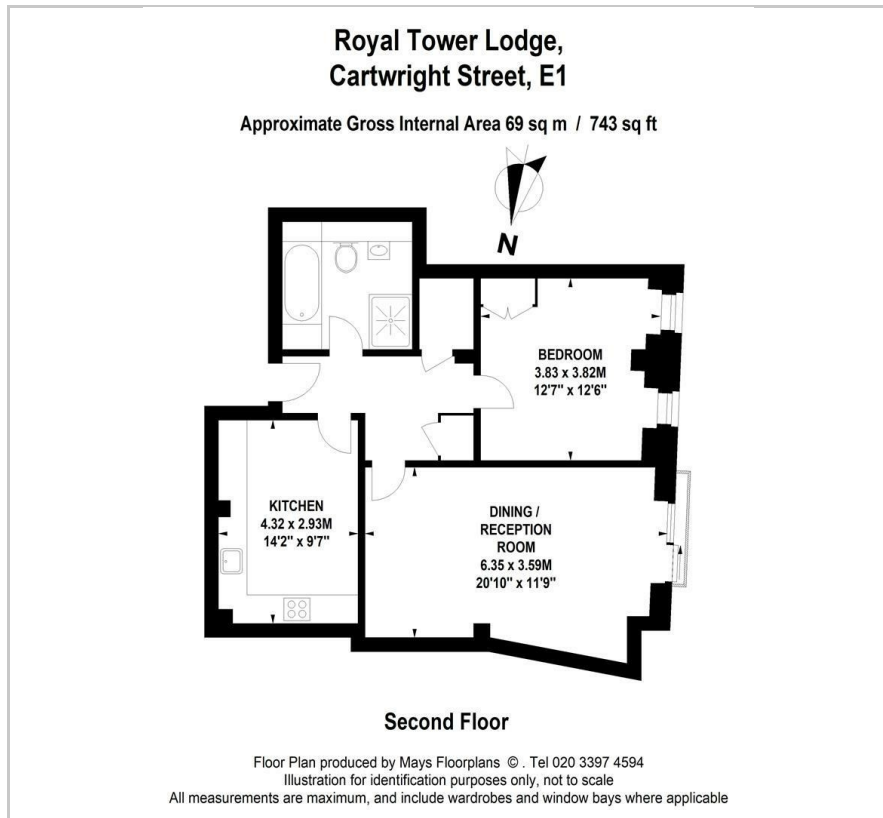

## Area Map

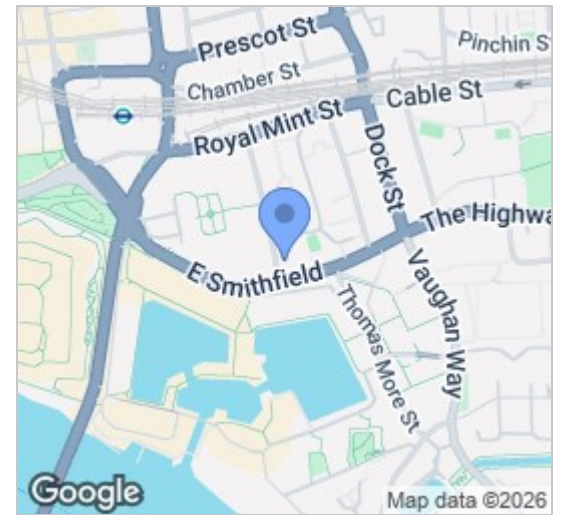

## Energy Efficiency Graph

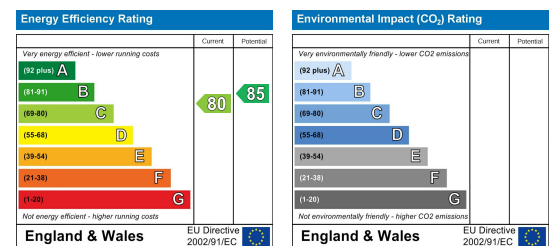

## Viewing

Please contact our Brothers Property Management Office on 020 4526 6150 if you wish to arrange a viewing appointment for this property or require further information.

- Approx. 743 Sq Ft
- Daytime Concierge
- Convenient Location
- 5 minutes' Walk to Tower Gateway Station
- Juliette Balcony
- Recently Refurbished Kitchen
- 2nd Floor
- Moments from St Katharine Docks
- 8 Minutes' Walk to Tower Hill Station
- Furnished



An extremely spacious one bedroom flat within a few minutes walk of the Tower of London and St. Katharine Docks



These particulars, whilst believed to be accurate are set out as a general outline only for guidance and do not constitute any part of an offer or contract. Intending purchasers should not rely on them as statements of representation of fact, but must satisfy themselves by inspection or otherwise as to their accuracy. No person in this firm's employment has the authority to make or give any representation or warranty in respect of the property.