

BROTHERS

PROPERTY MANAGEMENT



22 Royal Tower Lodge

London, E1 8LX

£1,950 Per month

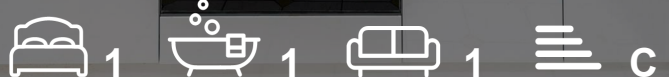
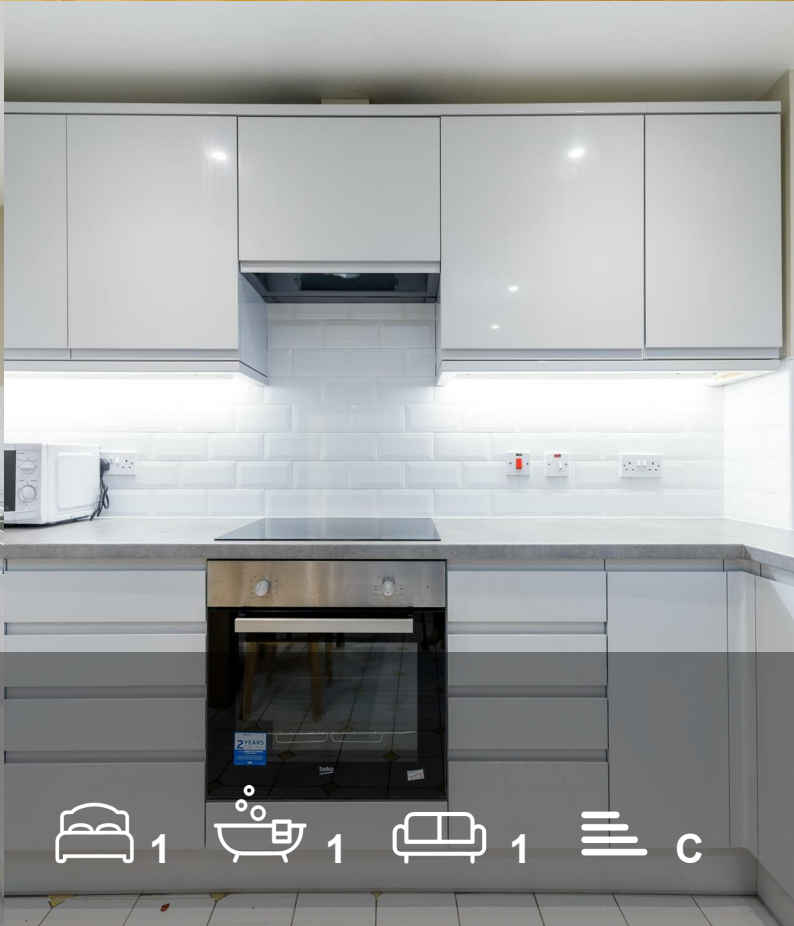

Floor Plan

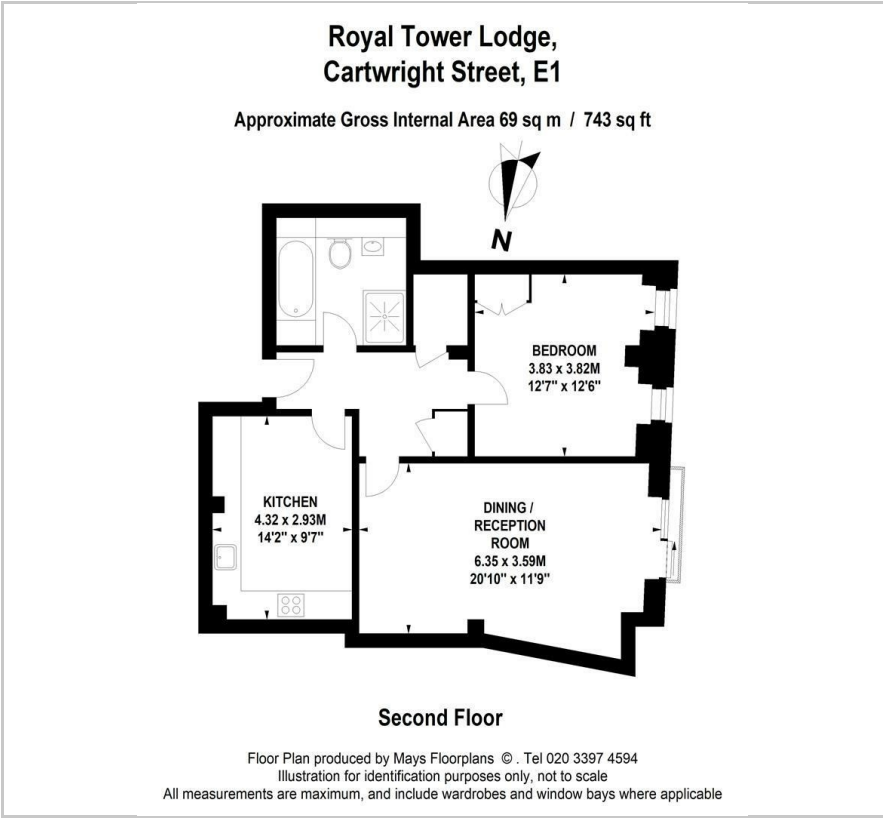

Area Map



Energy Efficiency Graph

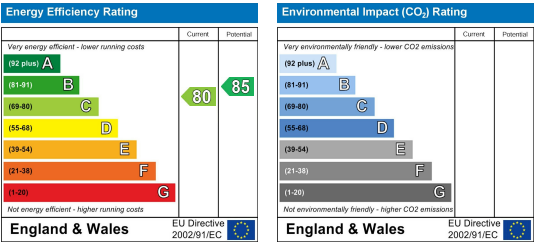

Viewing

Please contact our Brothers Property Management Office on 020 4526 6150 if you wish to arrange a viewing appointment for this property or require further information.

- Approx. 743 Sq Ft
- Daytime Concierge
- Convenient Location
- 5 minutes' Walk to Tower Gateway Station
- Juliette Balcony
- Recently Refurbished Kitchen
- 2nd Floor
- Moments from St Katharine Docks
- 8 Minutes' Walk to Tower Hill Station
- Furnished



These particulars, whilst believed to be accurate are set out as a general outline only for guidance and do not constitute any part of an offer or contract. Intending purchasers should not rely on them as statements of representation of fact, but must satisfy themselves by inspection or otherwise as to their accuracy. No person in this firms employment has the authority to make or give any representation or warranty in respect of the property.