



Tilbury Mead, Harlow, CM18 6JQ
£280,000



Tilbury Mead, Harlow, CM18 6JQ

Perfectly located within walking distance of excellent local schools, open fields and shops is this two double bedroom, end terrace family home. On the ground floor there is an entrance hallway leading to a large lounge, a kitchen/diner and a lean-to garden room, whilst upstairs there are two double bedrooms and a family bathroom with a three piece suite. Outside, the rear garden is mainly laid to lawn with a patio area and shed, with the front garden also laid to lawn. Early viewing is highly recommended.

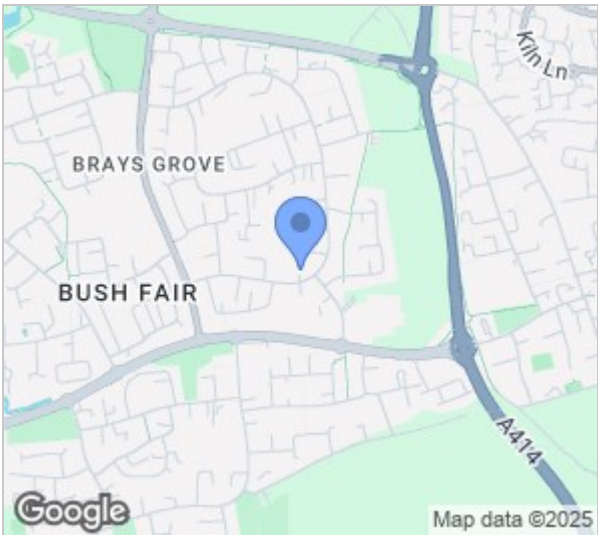
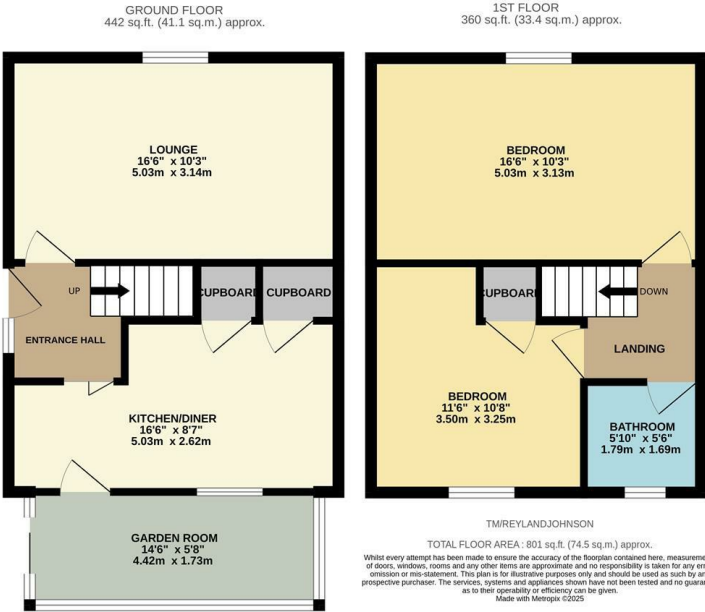

Energy Efficiency Rating			Environmental Impact (CO ₂) Rating		
	Current	Potential		Current	Potential
Very energy efficient - lower running costs			Very environmentally friendly - lower CO ₂ emissions		
(92 plus) A			(92 plus) A		
(81-91) B			(81-91) B		
(69-80) C			(69-80) C		
(55-68) D			(55-68) D		
(39-54) E			(39-54) E		
(21-38) F			(21-38) F		
(1-20) G			(1-20) G		
Not energy efficient - higher running costs			Not environmentally friendly - higher CO ₂ emissions		
England & Wales			England & Wales		
EU Directive 2002/91/EC			EU Directive 2002/91/EC		

These particulars, whilst believed to be accurate are set out as a general outline only for guidance and do not constitute any part of an offer or contract. Intending purchasers should not rely on them as statements of representation of fact, but must satisfy themselves by inspection or otherwise as to their accuracy. No person in this firms employment has the authority to make or give any representation or warranty in respect of the property.