



Gladwin Way, Harlow, CM20 1AS
£1,200 Per Month

1 bed 1 bath 1 sofa C

Gladwin Way, Harlow, CM20 1AS

Available now is this unfurnished, well presented one bedroom apartment is found in the popular Fifth Avenue Development. The property includes one allocated parking space, an open plan kitchen/diner with a juliette balcony off of the lounge and a secure door entry system. Gladwin Way is perfectly situated within walking distance to Harlow Town Train Station, Princess Alexandra Hospital and Harlow Town Centre. Unfurnished.

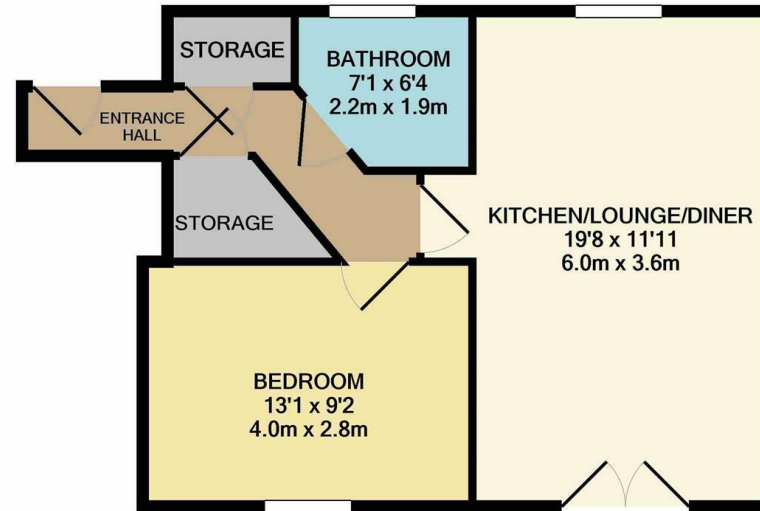
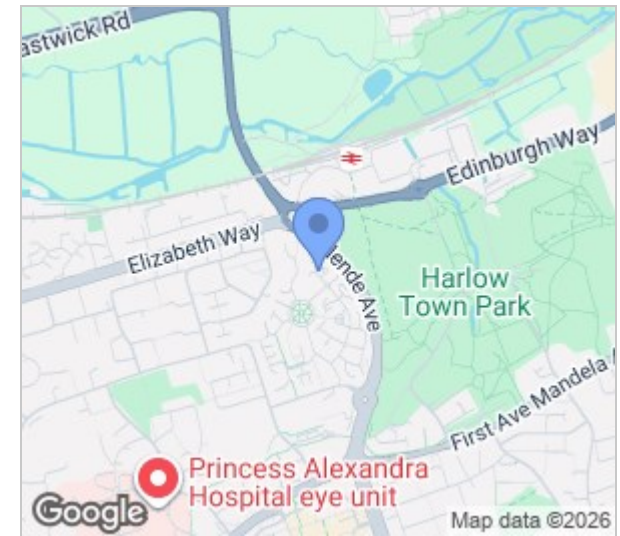

REYLANDJOHNSON/GW

TOTAL APPROX. FLOOR AREA 496 SQ.FT. (46.1 SQ.M.)

Whilst every attempt has been made to ensure the accuracy of the floor plan contained here, measurements of doors, windows, rooms and any other items are approximate and no responsibility is taken for any error, omission, or mis-statement. This plan is for illustrative purposes only and should be used as such by any prospective purchaser. The services, systems and appliances shown have not been tested and no guarantee as to their operability or efficiency can be given
Made with Metropix ©2020



Energy Efficiency Rating		Environmental Impact (CO ₂) Rating	
Current	Potential	Current	Potential
Very energy efficient - lower running costs			
Very environmentally friendly - lower CO ₂ emissions			
<p>80</p> <p>80</p>		<p>84</p> <p>85</p>	
England & Wales		England & Wales	
EU Directive 2002/91/EC		EU Directive 2002/91/EC	

These particulars, whilst believed to be accurate are set out as a general outline only for guidance and do not constitute any part of an offer or contract. Intending purchasers should not rely on them as statements of representation of fact, but must satisfy themselves by inspection or otherwise as to their accuracy. No person in this firm's employment has the authority to make or give any representation or warranty in respect of the property.

T. 01279 216216 E. info@rjestateagents.co.uk

1 Acorn Mews, Harlow, Essex, CM18 6NA www.rjestateagents.co.uk