



Morton Peto Road, Bishops Stortford, CM23 3ZF  
£1,750 Per Month

2 1 1 B

# Morton Peto Road, Bishops Stortford, CM23 3ZF

Located just a stones throw from Bishops Stortford Train Station is this brand new, two double bedroom top floor apartment, AVAILABLE NOW on a furnished basis. The property is spacious & light, with generous accommodation, consisting of an entrance hallway leading to an open plan lounge/kitchen/diner with a range of fitted wall and base units and appliances, a balcony, two double bedrooms, and a modern bathroom.



GROUND FLOOR  
711 sq.ft. (66.0 sq.m.) approx.

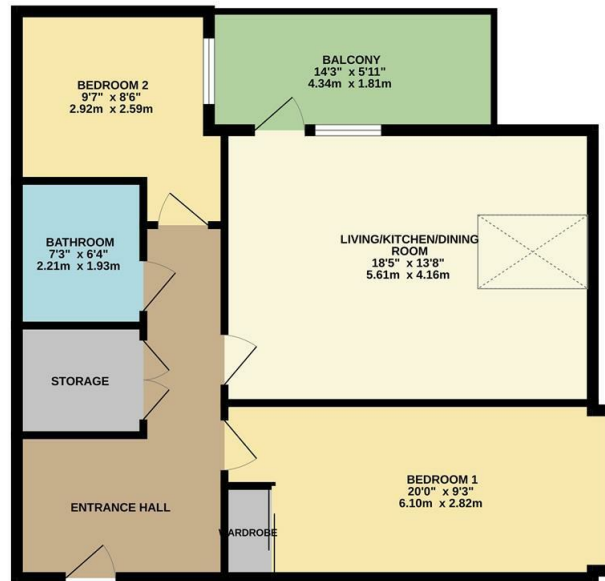

TOTAL FLOOR AREA: 711 sq.ft. (66.0 sq.m.) approx.  
While every attempt has been made to ensure the accuracy of the floorplan contained here, measurements of doors, windows, balconies and any other items are approximate and no responsibility is taken for any error or omission in this document. The floor plan is intended as a guide only and should not be used as a basis for any prospective purchase. The services, systems and appliances shown have not been tested and no guarantee is given as to their operability or efficiency can be given.  
Made with Metrepx 12020

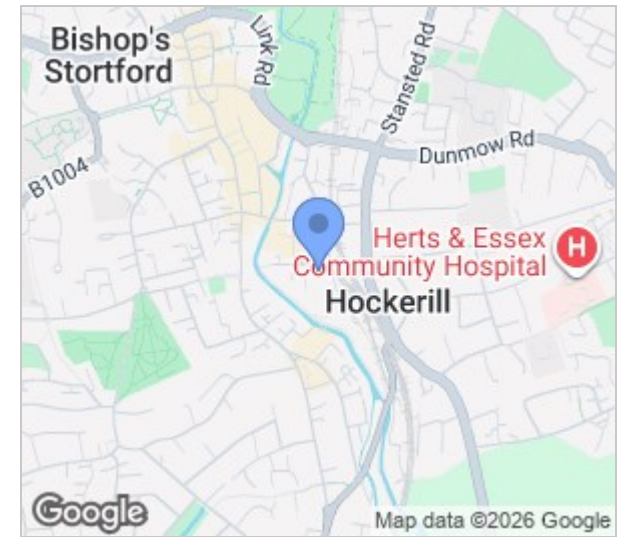

Energy Efficiency Rating		Current	Potential
Very energy efficient - lower running costs			
(92 plus) A			
(81-91) B			
(69-80) C			
(55-68) D			
(39-54) E			
(21-38) F			
(1-20) G			
Not energy efficient - higher running costs			
England & Wales	EU Directive 2002/91/EC	83	

Environmental Impact (CO <sub>2</sub> ) Rating		Current	Potential
Very environmentally friendly - lower CO <sub>2</sub> emissions			
(92 plus) A			
(81-91) B			
(69-80) C			
(55-68) D			
(39-54) E			
(21-38) F			
(1-20) G			
Not environmentally friendly - higher CO <sub>2</sub> emissions			
England & Wales	EU Directive 2002/91/EC		

These particulars, whilst believed to be accurate are set out as a general outline only for guidance and do not constitute any part of an offer or contract. Intending purchasers should not rely on them as statements of representation of fact, but must satisfy themselves by inspection or otherwise as to their accuracy. No person in this firm's employment has the authority to make or give any representation or warranty in respect of the property.

T. 01279 216216 E. info@rjestateagents.co.uk

1 Acorn Mews, Harlow, Essex, CM18 6NA www.rjestateagents.co.uk