



Tickenhall Drive, Harlow, CM17 9PF
£1,500 Per Month



Tickenhall Drive, Harlow, CM17 9PF

AVAILABLE MID JULY is this two double bedroom home with two allocated parking spaces in a quiet cul-de-sac in Tickenhall Drive, Church Langley. The property comprises an entrance hallway leading to a large lounge/diner, kitchen with a range of fitted wall and base units and cloakroom/WC, while on the first floor are two double bedrooms and a family bathroom with a white three piece suite. The rear garden is mainly laid to lawn with a patio area and side access out onto the car parking area. Tickenhall Drive is found just off Church Langley Way, within walking distance of local schools, shops and open fields.

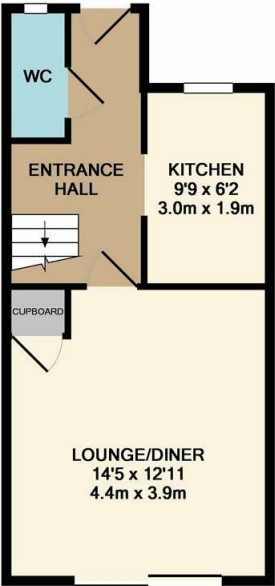

GROUND FLOOR

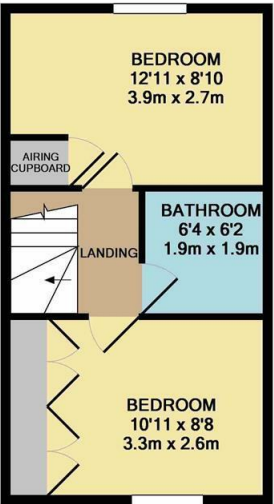

1ST FLOOR

TD/REYLANDJOHNSON

Whilst every attempt has been made to ensure the accuracy of the floor plan contained here, measurements of doors, windows, rooms and any other items are approximate and no responsibility is taken for any error, omission, or mis-statement. This plan is for illustrative purposes only and should be used as such by any prospective purchaser. The services, systems and appliances shown have not been tested and no guarantee as to their operability or efficiency can be given
Made with Metropix ©2019

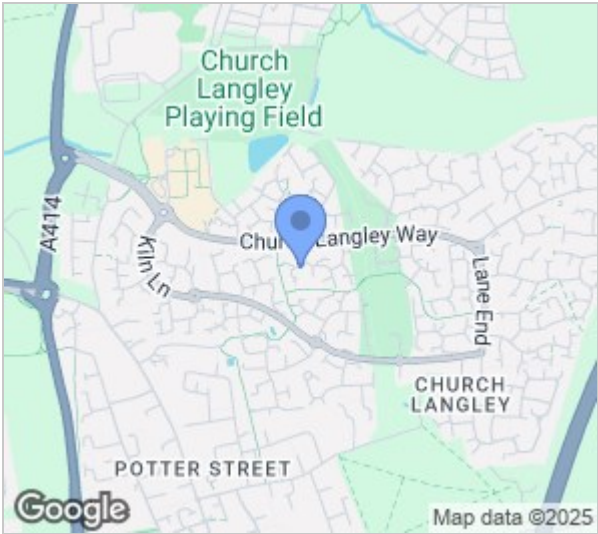

Energy Efficiency Rating		
	Current	Potential
Very energy efficient - lower running costs		
(92 plus) A		
(81-91) B		
(69-80) C		
(55-68) D		
(39-54) E		
(21-38) F		
(1-20) G		
Not energy efficient - higher running costs		
England & Wales		
EU Directive 2002/91/EC		

Environmental Impact (CO ₂) Rating		
	Current	Potential
Very environmentally friendly - lower CO ₂ emissions		
(92 plus) A		
(81-91) B		
(69-80) C		
(55-68) D		
(39-54) E		
(21-38) F		
(1-20) G		
Not environmentally friendly - higher CO ₂ emissions		
England & Wales		
EU Directive 2002/91/EC		

These particulars, whilst believed to be accurate are set out as a general outline only for guidance and do not constitute any part of an offer or contract. Intending purchasers should not rely on them as statements of representation of fact, but must satisfy themselves by inspection or otherwise as to their accuracy. No person in this firms employment has the authority to make or give any representation or warranty in respect of the property.