



Kingsland, Harlow, CM18 6XJ
£1,350 Per Month

3 1 2 D

A set of icons representing property features: a bed icon for 3 bedrooms, a bathtub icon for 1 bathroom, a sofa icon for 2 sofas, and a garage icon for a double garage.

Kingsland, Harlow, CM18 6XJ

A three bedroom family home with a modern kitchen in a popular location. The property has an entrance hall, lounge, separate dining area, utility room and fitted kitchen with a range of wall and base units. The first floor has three good size bedrooms and a family bathroom with three-piece suite and the outside has a long front garden and enclosed rear garden which is laid to patio and lawn. Kingsland is a popular location, situated between Staple Tye and Harlow Town centre, just over a mile to the M11 and close to shops and schooling. AVAILABLE End of November on an unfurnished basis.

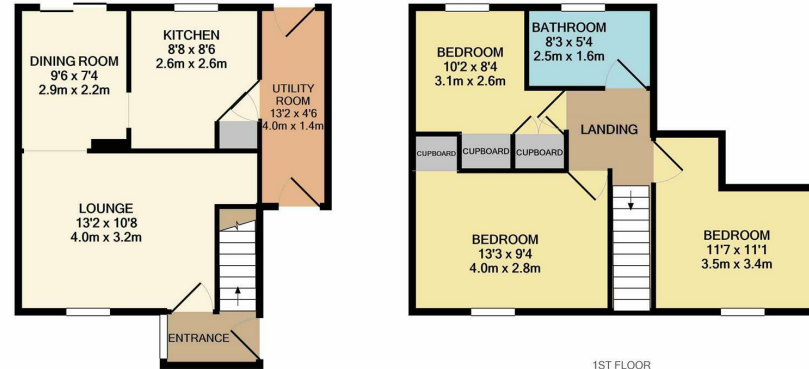

GROUND FLOOR
APPROX. FLOOR
AREA 402 SQ.FT.
(37.3 SQ.M.)

1ST FLOOR
APPROX. FLOOR
AREA 428 SQ.FT.
(39.8 SQ.M.)

REYLANDJOHNSON/KL
TOTAL APPROX. FLOOR AREA 830 SQ.FT. (77.1 SQ.M.)
Whilst every attempt has been made to ensure the accuracy of the floor plan contained here, measurements of doors, windows, rooms and any other items are approximate and no responsibility is taken for any error, omission, or mis-statement. This plan is for illustrative purposes only and should be used as such by any prospective purchaser. The services, systems and appliances shown have not been tested and no guarantee as to their operability or efficiency can be given
Made with Metropix ©2021



Energy Efficiency Rating		Current	Potential
Very energy efficient - lower running costs			
(92 plus) A			
(81-91) B			
(69-80) C			
(55-68) D			
(39-54) E			
(21-38) F			
(1-20) G			
Not energy efficient - higher running costs			
England & Wales			
	EU Directive 2002/91/EC		

Environmental Impact (CO ₂) Rating		Current	Potential
Very environmentally friendly - lower CO ₂ emissions			
(92 plus) A			
(81-91) B			
(69-80) C			
(55-68) D			
(39-54) E			
(21-38) F			
(1-20) G			
Not environmentally friendly - higher CO ₂ emissions			
England & Wales			
	EU Directive 2002/91/EC		

These particulars, whilst believed to be accurate are set out as a general outline only for guidance and do not constitute any part of an offer or contract. Intending purchasers should not rely on them as statements of representation of fact, but must satisfy themselves by inspection or otherwise as to their accuracy. No person in this firm's employment has the authority to make or give any representation or warranty in respect of the property.

T. 01279 216216 E. info@rjestateagents.co.uk

1 Acorn Mews, Harlow, Essex, CM18 6NA www.rjestateagents.co.uk