



Aylets Field, Harlow, CM18 7LW
£1,000 Per Month

2 1 1 D

Aylets Field, Harlow, CM18 7LW

AVAILABLE NOW on an unfurnished basis is this two bedroom ground floor apartment with allocated parking. The property comprises an entrance hallway leading to an open plan lounge/diner and kitchen with a range of fitted wall and base units, Two bedrooms with fitted wardrobes to the master and a bathroom with a white three piece suite. Outside there are communal gardens and allocated parking.

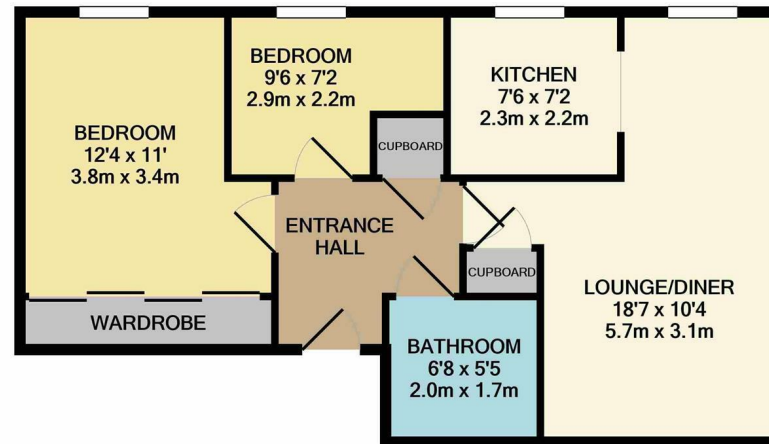

AF/RJ
 TOTAL APPROX. FLOOR AREA 548 SQ.FT. (50.9 SQ.M.)
 Whilst every attempt has been made to ensure the accuracy of the floor plan contained here, measurements of doors, windows, rooms and any other items are approximate and no responsibility is taken for any error, omission, or mis-statement. This plan is for illustrative purposes only and should be used as such by any prospective purchaser. The services, systems and appliances shown have not been tested and no guarantee as to their operability or efficiency can be given
 Made with Metropix ©2020

Energy Efficiency Rating		Environmental Impact (CO ₂) Rating	
Current	Potential	Current	Potential
Very energy efficient - lower running costs		Very environmentally friendly - lower CO ₂ emissions	
(92 plus) A		(81-91) A	
(81-91) B		(69-80) B	
(69-80) C		(55-68) C	
(55-68) D	65	(39-54) D	62
(39-54) E		(21-38) E	46
(21-38) F		(1-20) F	
(1-20) G		(1-20) G	
Not energy efficient - higher running costs		Not environmentally friendly - higher CO ₂ emissions	
England & Wales		England & Wales	
EU Directive 2002/91/EC		EU Directive 2002/91/EC	

These particulars, whilst believed to be accurate are set out as a general outline only for guidance and do not constitute any part of an offer or contract. Intending purchasers should not rely on them as statements of representation of fact, but must satisfy themselves by inspection or otherwise as to their accuracy. No person in this firm's employment has the authority to make or give any representation or warranty in respect of the property.

T. 01279 216216 E. info@rjestateagents.co.uk

1 Acorn Mews, Harlow, Essex, CM18 6NA www.rjestateagents.co.uk