



Morley Grove, Harlow, CM20 1ED
£1,700 Per Month



Morley Grove, Harlow, CM20 1ED

A four bedroom terraced town house with driveway to the front. The property comprises an entrance hall leading to a kitchen/diner, utility room, ground floor WC, study, first floor landing, double bedroom, lounge, shower room, second floor landing, three further bedrooms and a family bathroom. Outside the rear garden is low maintenance. Morley Grove is located close to Harlow town centre and Princess Alexandra hospital. Available NOW on an unfurnished basis.

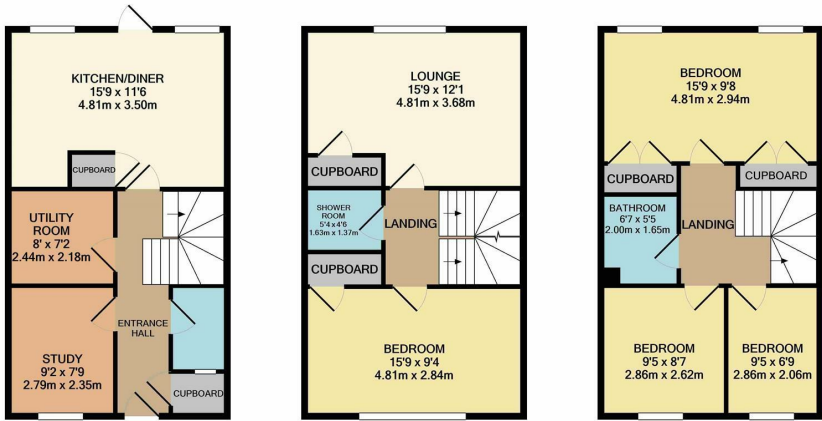

GROUND FLOOR
APPROX. FLOOR
AREA 439 SQ.FT.
(40.8 SQ.M.)

1ST FLOOR
APPROX. FLOOR
AREA 439 SQ.FT.
(40.8 SQ.M.)

2ND FLOOR
APPROX. FLOOR
AREA 437 SQ.FT.
(40.6 SQ.M.)

REYLANDJOHNSON/MG
TOTAL APPROX. FLOOR AREA 1315 SQ.FT. (122.2 SQ.M.)
Whilst every attempt has been made to ensure the accuracy of the floor plan contained here, measurements of doors, windows, rooms and any other items are approximate and no responsibility is taken for any error, omission, or mis-statement. This plan is for illustrative purposes only and should be used as such by any prospective purchaser. The services, systems and appliances shown have not been tested and no guarantee as to their operability or efficiency can be given.
Made with Metropix ©2022

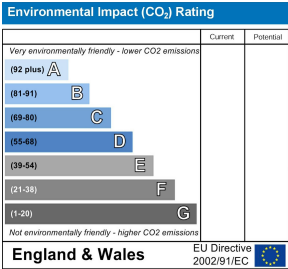
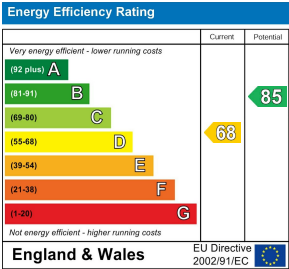

These particulars, whilst believed to be accurate are set out as a general outline only for guidance and do not constitute any part of an offer or contract. Intending purchasers should not rely on them as statements of representation of fact, but must satisfy themselves by inspection or otherwise as to their accuracy. No person in this firms employment has the authority to make or give any representation or warranty in respect of the property.