



The Downs, Harlow, CM20 3RH
£300,000



The Downs, Harlow, CM20 3RH

This two bedroom end terrace home located within walking distance of Harlow Town Centre. The property itself offers a good size lounge/diner, galley style kitchen with a range of wall and base units, utility room, two double bedrooms and a well looked after family bathroom. The garden is approximately 50ft long and mostly laid to lawn with some patio space. The Downs is located within walking distance of open fields, shops, schools and Harlow Town Park.

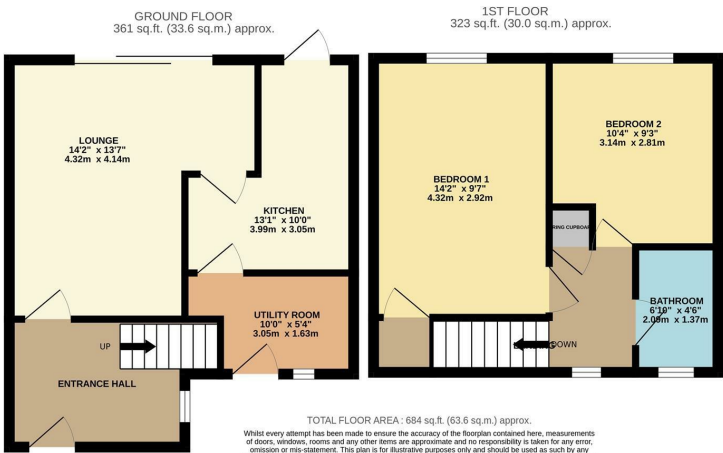

Energy Efficiency Rating			Environmental Impact (CO ₂) Rating		
	Current	Potential		Current	Potential
Very energy efficient - lower running costs			Very environmentally friendly - lower CO ₂ emissions		
(92 plus) A			(92 plus) A		
(81-91) B			(81-91) B		
(69-80) C			(69-80) C		
(55-68) D			(55-68) D		
(39-54) E			(39-54) E		
(21-38) F			(21-38) F		
(1-20) G			(1-20) G		
Not energy efficient - higher running costs			Not environmentally friendly - higher CO ₂ emissions		
England & Wales			England & Wales		
EU Directive 2002/91/EC			EU Directive 2002/91/EC		

These particulars, whilst believed to be accurate are set out as a general outline only for guidance and do not constitute any part of an offer or contract. Intending purchasers should not rely on them as statements of representation of fact, but must satisfy themselves by inspection or otherwise as to their accuracy. No person in this firms employment has the authority to make or give any representation or warranty in respect of the property.