

**Wedhey, Harlow, CM19 4AE**  
**£1,200 Per Month**

- Two Bedrooms
- First-Floor Flat
- Modern Kitchen & Bathroom
- Unfurnished
- Spacious Lounge/Diner
- Available Mid September

# Wedhey, Harlow, CM19 4AE

## £1,200 Per Month

A well-presented, two bedroom, first-floor flat in the popular turning of Wedhey. This spacious home has been comprises of an entrance hall with a storage area, a modern kitchen, lounge/diner with juliet balcony, two double bedrooms and a family bathroom with a three-piece suite. The property further benefits from a communal garden area and comes with outside storage. Wedhey is situated within walking distance to Harlow town centre and Princess Alexandra Hospital. Available Mid September on an unfurnished basis.

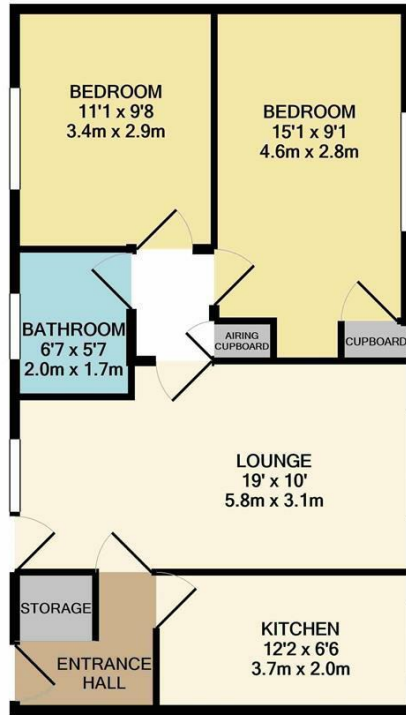

WH/REYLANDJOHNSON  
 TOTAL APPROX. FLOOR AREA 605 SQ.FT. (56.2 SQ.M.)

Whilst every attempt has been made to ensure the accuracy of the floor plan contained here, measurements of doors, windows, rooms and any other items are approximate and no responsibility is taken for any error, omission, or mis-statement. This plan is for illustrative purposes only and should be used as such by any prospective purchaser. The services, systems and appliances shown have not been tested and no guarantee as to their operability or efficiency can be given  
 Made with Metropix ©2021

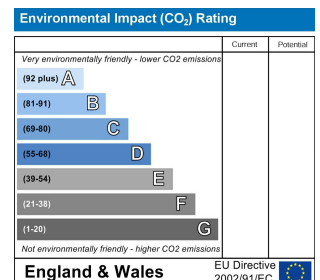
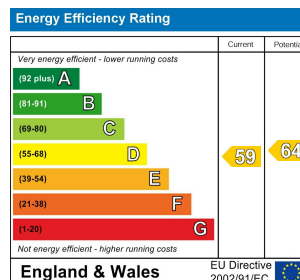

These particulars, whilst believed to be accurate are set out as a general outline only for guidance and do not constitute any part of an offer or contract. Intending purchasers should not rely on them as statements of representation of fact, but must satisfy themselves by inspection or otherwise as to their accuracy. No person in this firm's employment has the authority to make or give any representation or warranty in respect of the property.