



Chelsea Gardens, Harlow, CM17 9RX
£240,000



Chelsea Gardens, Harlow, CM17 9RX

Offered with no onward chain, this two bedroom ground floor apartment built by Bellway Homes in the late 1990's. The property offers a larger than average lounge/diner, kitchen with a range of wall and base units, modern bathroom with three piece suite, two double bedrooms and an allocated parking space. Chelsea Gardens is regarded as one of the most desirable development of apartments in Church Langley and is located off Lane End, alongside Davenport. Agents Notes: Lease Remaining - 99 Years. Service Charge - £1300. Ground Rent - £150pa

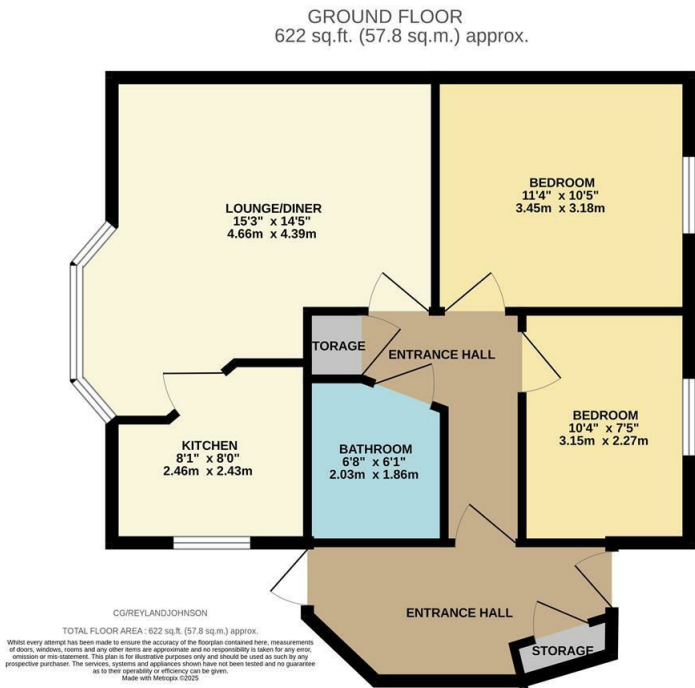

Energy Efficiency Rating		
	Current	Potential
Very energy efficient - lower running costs		
(92 plus) A		
(81-91) B		
(69-80) C		
(55-68) D		
(39-54) E		
(21-38) F		
(1-20) G		
Not energy efficient - higher running costs		
England & Wales	EU Directive 2002/91/EC	EU Directive 2002/91/EC

Environmental Impact (CO ₂) Rating		
	Current	Potential
Very environmentally friendly - lower CO ₂ emissions		
(92 plus) A		
(81-91) B		
(69-80) C		
(55-68) D		
(39-54) E		
(21-38) F		
(1-20) G		
Not environmentally friendly - higher CO ₂ emissions		
England & Wales	EU Directive 2002/91/EC	EU Directive 2002/91/EC

These particulars, whilst believed to be accurate are set out as a general outline only for guidance and do not constitute any part of an offer or contract. Intending purchasers should not rely on them as statements of representation of fact, but must satisfy themselves by inspection or otherwise as to their accuracy. No person in this firms employment has the authority to make or give any representation or warranty in respect of the property.