



**£137,500**

Townend Estate Agents are delighted to present this beautifully renovated two-bedroom end stone terrace property, situated in the sought-after residential area of Eccleshill, BD2.

The accommodation comprises a spacious reception room, a modern fitted kitchen, two well-proportioned bedrooms, and a contemporary house bathroom. Externally, the property benefits from both front and rear gardens, providing excellent outdoor space.

This attractive home is ideally located close to a wide range of local amenities, including shops, reputable schools, and excellent public transport links.

Offering an ideal opportunity for first-time buyers and investors alike, this property is sure to generate significant interest. Early viewing is highly recommended.

Ask us about...

AUCTION

CONVEYANCING

MORTGAGES

SURVEYS

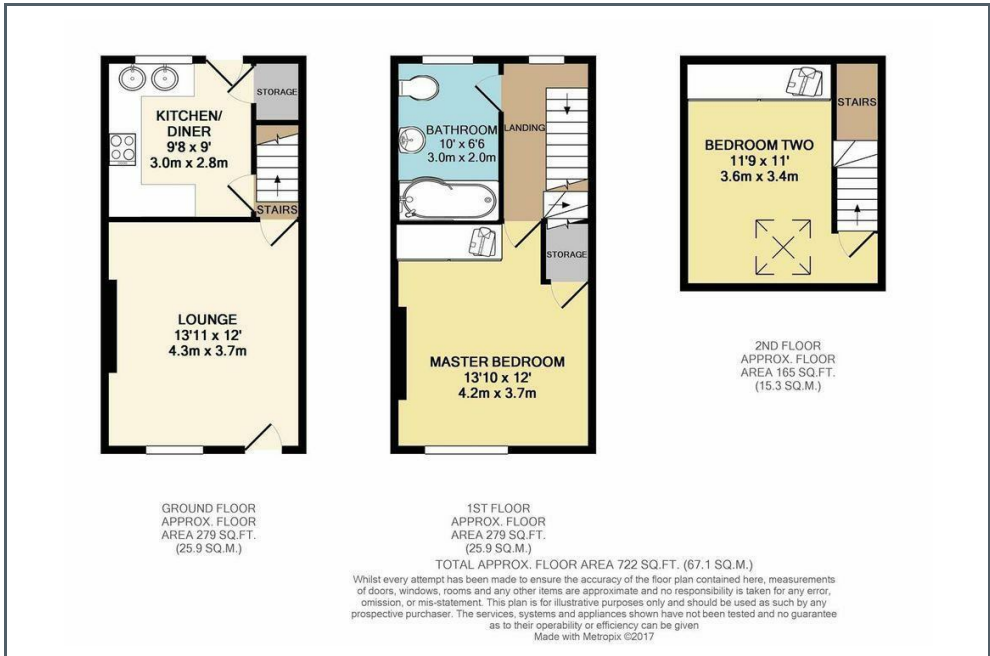

These particulars do not form part of any contract and no statements are made without any responsibility on the part of their clients. Applicants must investigate for themselves that statements are correct and no agent whether the partner or employee has the authority to make any representation or warranty whatsoever in respect of this property.

**IMPORTANT NOTICE: WHILST WE ENDEAVOUR TO MAKE OUR SALES DETAILS ACCURATE AND RELIABLE, THEY SHOULD NOT BE RELIED ON AS STATEMENTS OR REPRESENTATIONS OF FACT AND DO NOT IN ANY WAY CONSTITUTE A CONTRACT. PROSPECTIVE PURCHASERS SHOULD SATISFY THEMSELVES THAT DIMENSIONS ARE CORRECT AND THAT MAINS SERVICES ARE OPERATIONAL.**

