

HoldenCopley

PREPARE TO BE MOVED

Alder Gardens, Bulwell, Nottinghamshire NG6 7DN

Guide Price £100,000 - £110,000

Alder Gardens, Bulwell, Nottinghamshire NG6 7DN



GUIDE PRICE: £100,000 - £110,000

PERFECT FIRST TIME BUY

This two bedroom terraced house is situated in a popular location across the road from Snape Wood Primary School and with easy access to local amenities, a variety of shops and excellent transport links. The property would make the perfect purchase for any first time or investment buyer as it is sold with no upward chain and offers plenty of potential.

To the ground floor there is a hallway, a kitchen diner and a spacious lounge.

The first floor carries two good sized bedrooms serviced by the three piece bathroom suite, there is the possibility to convert the first floor to carry three bedrooms.

Outside there are generous sized gardens to both the front and rear of the property with a gated driveway.

MUST BE VIEWED





- Terraced House
- Two Bedrooms
- Modern Kitchen
- Spacious Living Room
- Three Piece Bathroom Suite
- Driveway
- Private Enclosed Garden
- No Upward Chain
- Freehold
- 360 Virtual Tour Available





GROUND FLOOR

Hallway

The hallway has carpeted flooring, a wall mounted radiator, a wall mounted security alarm system and thermostat, a built in storage cupboard, two single doors providing access into the accommodation and to the garden at the rear

Kitchen / Diner

13'3" x 9'4" (4.05 x 2.86)

The kitchen diner has a range of fitted wood effect base and wall units with rolled edge work surfaces, a white ceramic sink with full bowl, half bowl and full drainer with mixer taps, an integrated oven, a hob and a fridge freezer, a glass splash back, an extractor fan, a wall mounted wine rack, a wall mounted boiler, space and plumbing for a washing machine, space for a microwave, a wall mounted radiator and a double glazed window

Living Room

13'4" x 11'10" (4.07 x 3.62)

The living room has carpeted flooring, a TV point, a dado rail, coving to the ceiling, sliding doors to the garden and wall lights fixtures

FIRST FLOOR

Landing

The landing has carpeted flooring, a loft hatch, a wall mounted radiator, a storage cupboard and provides access to the first floor accommodation

Master Bedroom

16'5" x 9'8" (5.01 x 2.97)

The main bedroom has exposed wooden floorboards, a wall mounted radiator, a built in wardrobe, a dado rail and two double glazed windows

Bedroom Two

11'3" x 11'7" (3.44 x 3.54)

The second bedroom has exposed wooden floorboards, a wall mounted radiator and a double glazed window

Bathroom

8'0" x 5'11" (2.44 x 1.81)

The bathroom has wood effect flooring, a low level flush W/C, a pedestal wash basin, a panelled bath with an overhead shower, a chrome towel rail, two wall mounted glass shelves, part tiled walls and a double glazed window

OUTSIDE

Front

To the front of the property is a garden with fence panelling and an outdoor storage cupboard

Rear

To the rear of the property is a private enclosed garden with a lawn, a patio area, fence panelling, gated access and a gated driveway for one car

DISCLAIMER

Agents Disclaimer: HoldenCopley, their clients and employees I: Are not authorised to make or give any representations or warranties in relation to the property either here or elsewhere, either on their own behalf or on behalf of their client or otherwise. They assume no responsibility for any statement that may be made in these particulars. These particulars do not form part of any offer or contract and must not be relied upon as statements or representations of fact. 2: Any areas, measurements or distances are approximate. The text, photographs and plans are for guidance only and are not necessarily comprehensive. It should not be assumed that the property has all necessary planning, building regulation or other consents and HoldenCopley have not tested any services, equipment or facilities. Purchasers must make further investigations and inspections before entering into any agreement.

Purchaser information -The Money Laundering, Terrorist Financing and Transfer of Funds(Information on the Payer) Regulations 2017(MLR 2017) came into force on 26 June 2017. HoldenCopley require any successful purchasers proceeding with a property to provide two forms of identification i.e. passport or photocard driving license and a recent utility bill or bank statement. We are also required to obtain proof of funds and provide evidence of where the funds originated from. This evidence will be required prior to HoldenCopley removing a property from the market and instructing solicitors for your purchase.

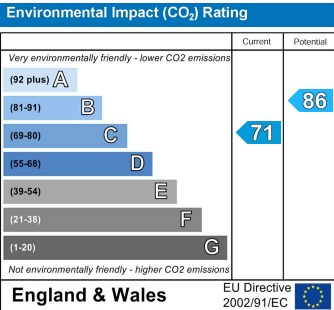
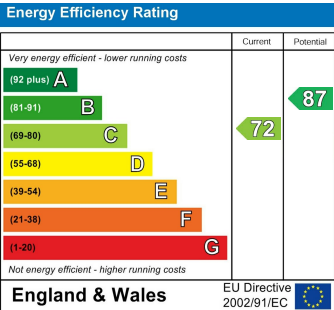

Alder Gardens, Bulwell, Nottinghamshire NG6 7DN

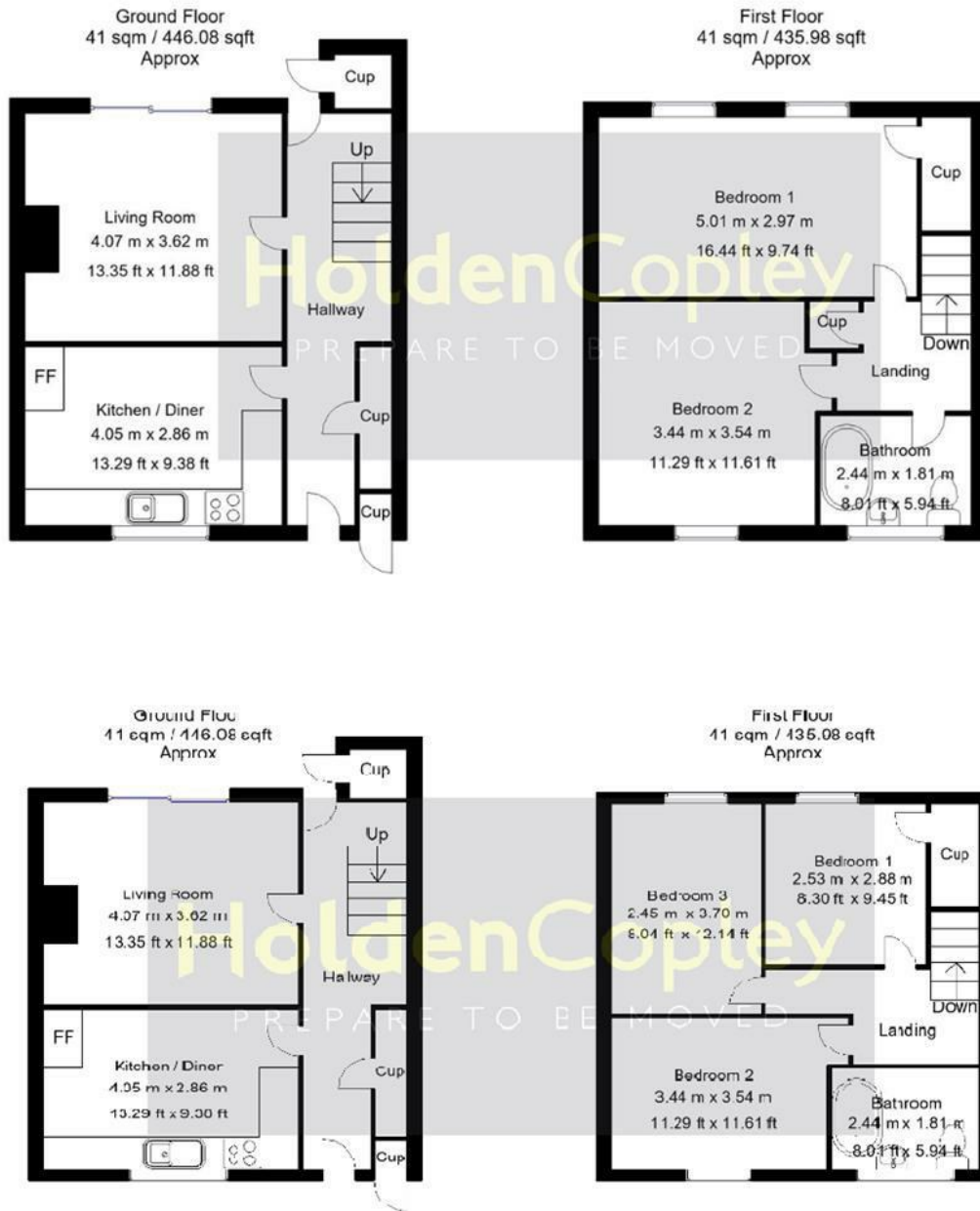

01156 972 972

33A High Street, Hucknall, Nottingham, NG15 7HJ

hucknaloffice@holdencopley.co.uk

www.holdencopley.co.uk

Agents Disclaimer: HoldenCopley, their clients and employees are not authorised to make or give any representations or warranties in relation to the property either here or elsewhere, either on their own behalf or on behalf of their client or otherwise. They assume no responsibility for any statement that may be made in these particulars. These particulars do not form part of any offer or contract and must not be relied upon as statements or representations of fact. 2: Any areas, measurements or distances are approximate. The text, photographs and plans are for guidance only and are not necessarily comprehensive. It should not be assumed that the property has all necessary planning, building regulation or other consents and HoldenCopley have not tested any services, equipment or facilities. Purchasers must make further investigations and inspections before entering into any agreement.