

Rolfe East



High Street, Harefield, UB9 6BU

Fixed Asking Price £520,000

- A5 licenced 1200sq food restaurant/approx. 1905 sq ft including residential above
- Potential for good yield
- 2/3 bedroom residential
- Renovation required

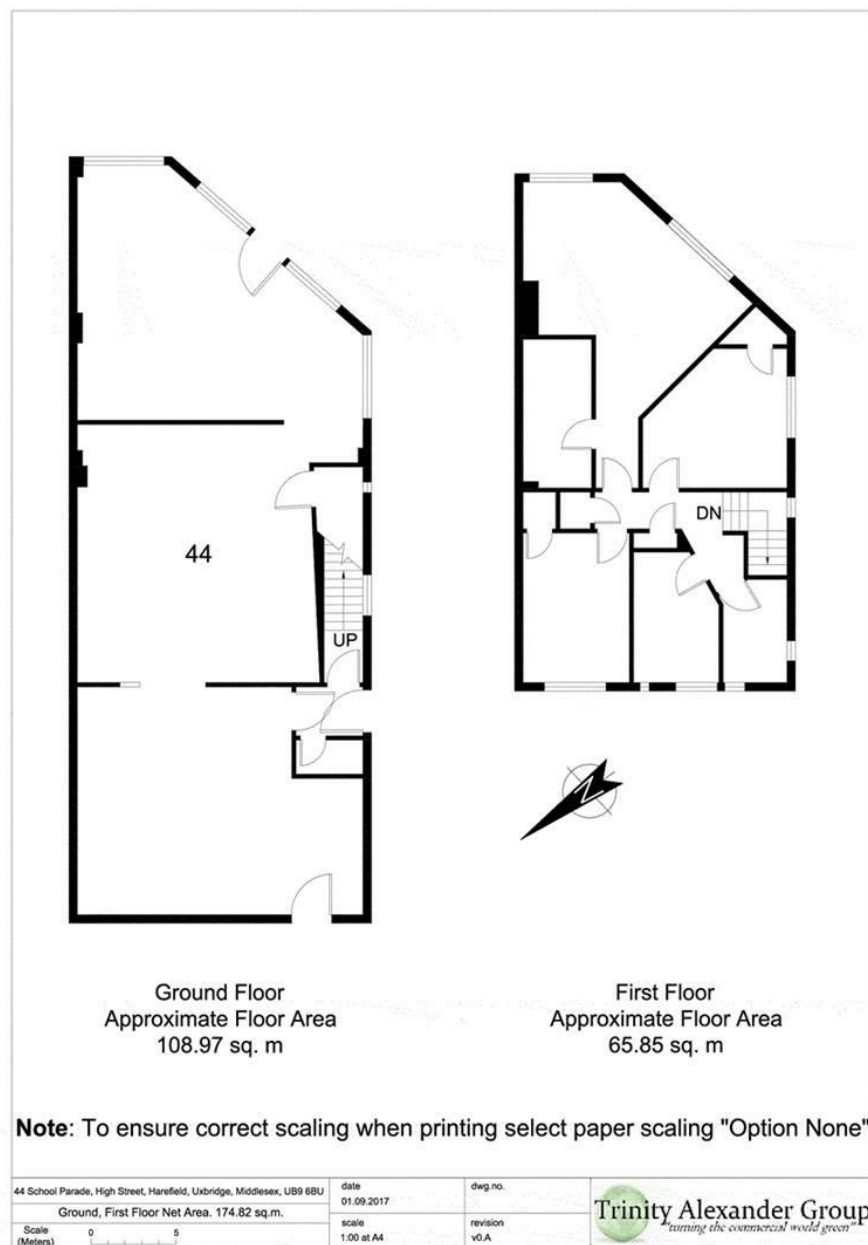

Viewings

Viewings by arrangement only.
Call 020 8566 0288 to make an appointment.

Council Tax Band

Exempt

EPC Rating:

E

Energy Efficiency Rating		
	Current	Potential
Very energy efficient - lower running costs		
(92 plus) A		
(81-91) B		
(69-80) C		
(55-68) D		
(39-54) E	54	
(21-38) F		
(1-20) G		
Not energy efficient - higher running costs		
England & Wales	EU Directive 2002/91/EC 