

# Rolfe East



Northfield Avenue, W13 9RR

£275,000

- High Footfall Location
- Close to Northfields Tube (Piccadilly line)
- Retail Unit
- 999 Year Lease

44 Pitshanger Lane, Ealing, W5 1QY  
020 8566 0288

[commercial@rolfe-east.com](mailto:commercial@rolfe-east.com)  
<https://www.rolfe-east.com/>

Northfield Avenue (commercial unit), London, W13  
 Approximate Floor Area = 26.2 sq m / 282 sq ft

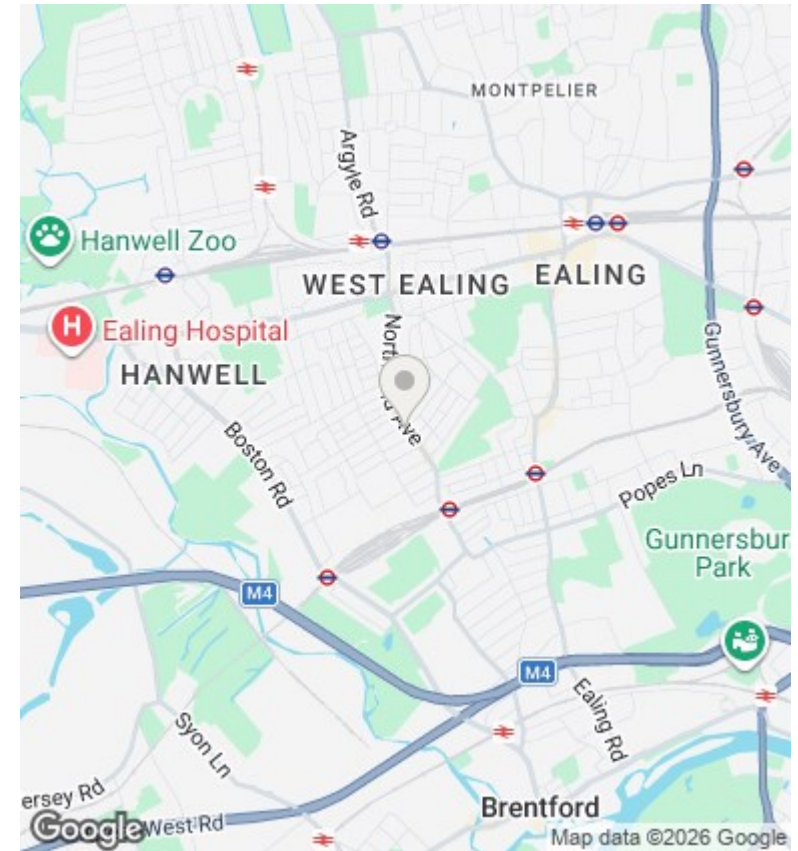
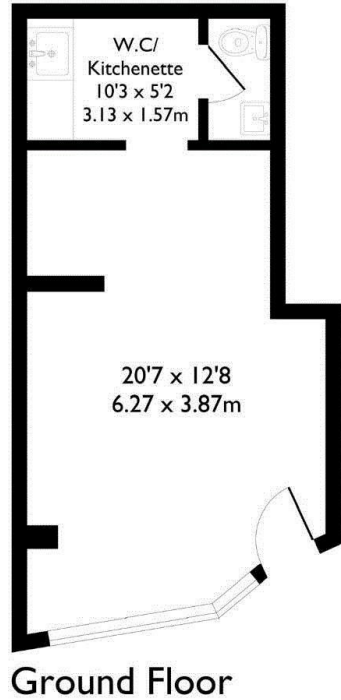

## Directions

## Viewings

Viewings by arrangement only. Call 020 8566 0288 to make an appointment.

## Council Tax Band

## EPC Rating:

Energy Efficiency Rating		Current	Potential
<i>Very energy efficient - lower running costs</i>			
(92 plus) <b>A</b>			
(81-91) <b>B</b>			
(69-80) <b>C</b>			
(55-68) <b>D</b>			
(39-54) <b>E</b>			
(21-38) <b>F</b>			
(1-20) <b>G</b>			
<i>Not energy efficient - higher running costs</i>			
<b>England &amp; Wales</b>		EU Directive 2002/91/EC	