

Rolfe East



South Ealing Road, W5

£500,000

- Great Location
- Ground Floor Commercial Premises
- Side Access via Temple Road

18-19 The Mall, Ealing, W5 2PJ
020 8566 0288

commercial@rolfe-east.com
<https://www.rolfe-east.com/>

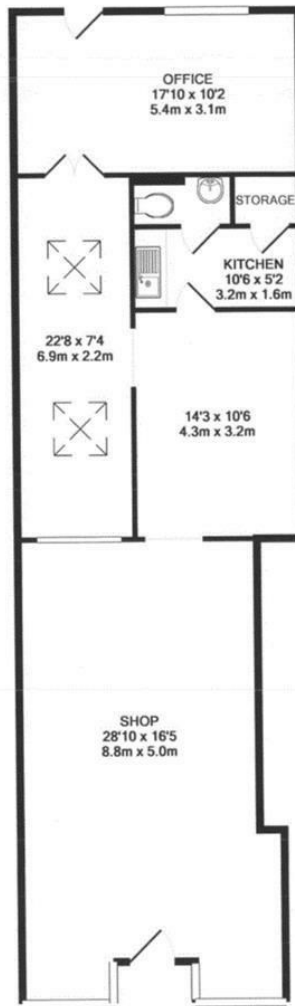

TOTAL APPROX. FLOOR AREA 1016 SQ.FT. (94.4 SQ.M.)

Whilst every attempt has been made to ensure the accuracy of the floor plan contained here, measurement of doors, windows, rooms and any other items are approximate and no responsibility is taken for any omission, or mis-statement. This plan is for illustrative purposes only and should be used as such by its respective purchaser. The services, systems and appliances shown have not been tested and no guarantee as to their operability or efficiency can be given.

Made with Metropix ©2013

Viewings

Viewings by arrangement only.
Call 020 8566 0288 to make an appointment.