

Rolfe East



Chamberlain Gardens, Hounslow, TW3 4NF

£315,000

- Purpose built development
- Chain free sale
- Ground Floor Apartment
- Two Double Bedrooms with built in wardrobes
- Allocated Parking
- Close to Transport Links
- Cul de sac

289 Northfield Avenue, Ealing, W5 4XB
020 8579 1111

northfields@rolfe-east.com
<https://www.rolfe-east.com/>

Chamberlain Gardens
 Approximate Gross Internal Area = 58.0 sq m / 624 sq ft

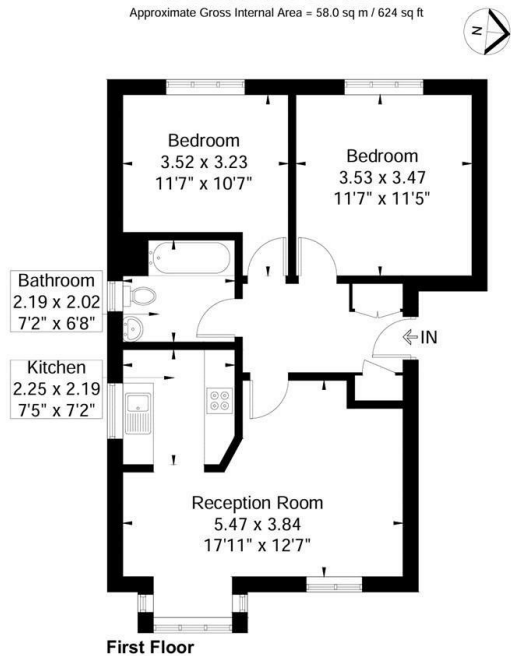

Although every attempt has been made to ensure accuracy, all measurements are approximate. The floorplan is for illustrative purposes only and not to scale.
 © www.perspective.co.uk

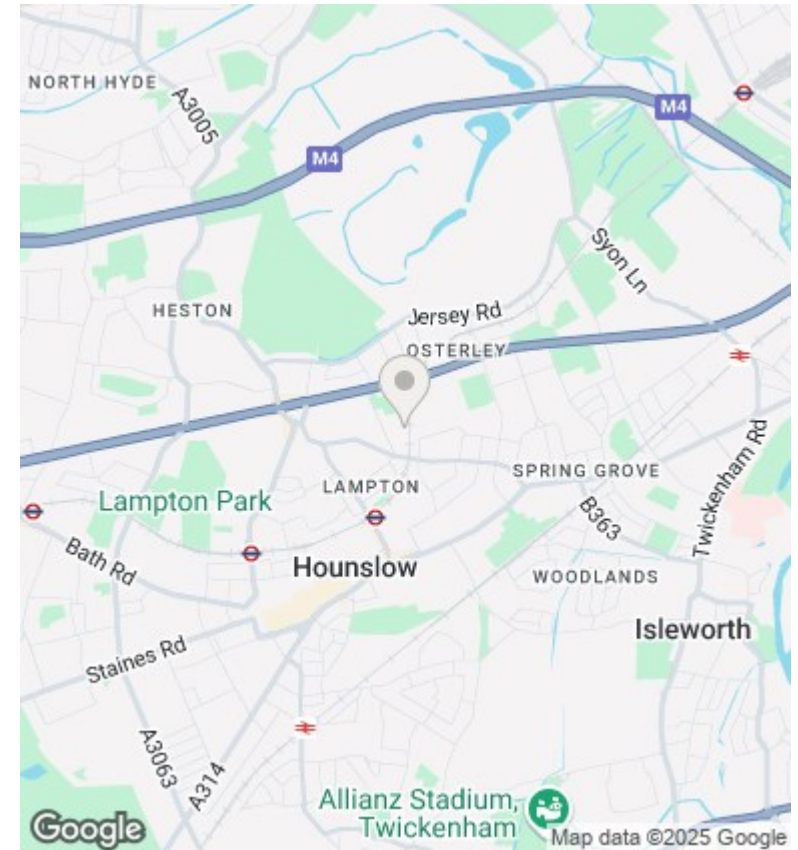

Directions

Viewings

Viewings by arrangement only. Call 020 8579 1111 to make an appointment.

Council Tax Band

C

EPC Rating:

D

Energy Efficiency Rating		Current	Potential
Very energy efficient - lower running costs			
(92 plus) A			
(81-91) B			77
(69-80) C			
(55-68) D		60	
(39-54) E			
(21-38) F			
(1-20) G			
Not energy efficient - higher running costs			
England & Wales		EU Directive 2002/91/EC	