

Butler's

thoughtful estate agency



Harold Road
Sutton, SM1 4HZ
Offers over £400,000



Harold Road, Sutton, SM1 4HZ

Positioned in one of Sutton's most convenient roads this property has so much to offer. Firstly, we have to talk location. Have you ever dreamed of living in a quiet road, yet on the doorstep of fabulous amenities, open spaces, schools and transport links? Harold road will surpass your expectations, as it's just a quick stroll into the high street, with outstanding schooling and Sutton station providing quick links into the City - you'll be able to get into town in under an hour. So what about inside the property? Having a generous living/dining area, this property is perfect for hosting those dinner parties and entertaining all of your friends and family. You can also open up the door from the modern kitchen and spill straight out into the low-maintenance, tiered rear garden. Upstairs, this house doesn't let you down; with two bedrooms, there will be no grumbles from the kids or guests with their room! So if you're looking for your first home to put your own stamp on, downsizing or ready for your next investment, you will not want to miss this one.



GROUND FLOOR

Vestibule

Living/Dining Room
20'9 x 11'1 (6.32m x 3.38m)

Kitchen
10'11 x 5'9 (3.33m x 1.75m)

Bathroom
8'1 x 4'10 (2.46m x 1.47m)

FIRST FLOOR

Landing

Bedroom
11' x 9'11 (3.35m x 3.02m)

Bedroom
10'8 x 8'4 (3.25m x 2.54m)

OUTSIDE

Rear Garden

Area Map

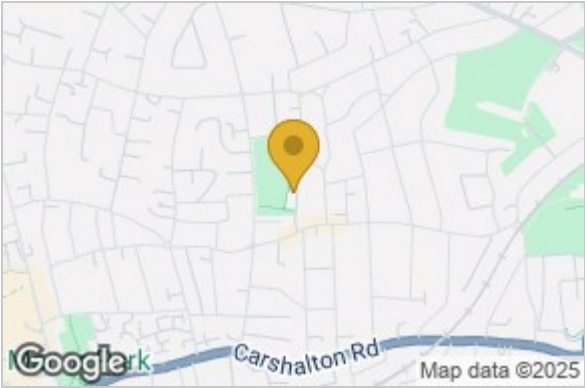

Floor Plan

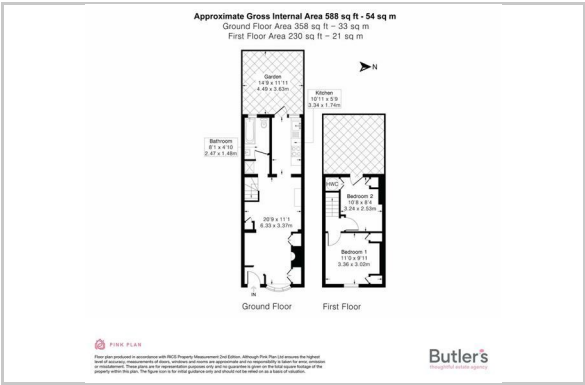

Energy Efficiency Graph

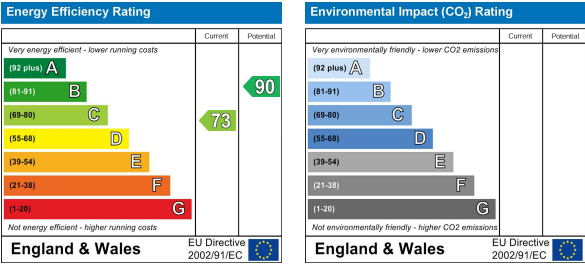

These particulars, whilst believed to be accurate are set out as a general outline only for guidance and do not constitute any part of an offer or contract. Intending purchasers should not rely on them as statements of representation of fact, but must satisfy themselves by inspection or otherwise as to their accuracy. No person in this firms employment has the authority to make or give any representation or warranty in respect of the property.