

Butler's

thoughtful estate agency



Roseacre Close, Sutton, SM1 3LT
Guide price £550,000



Floor Plan

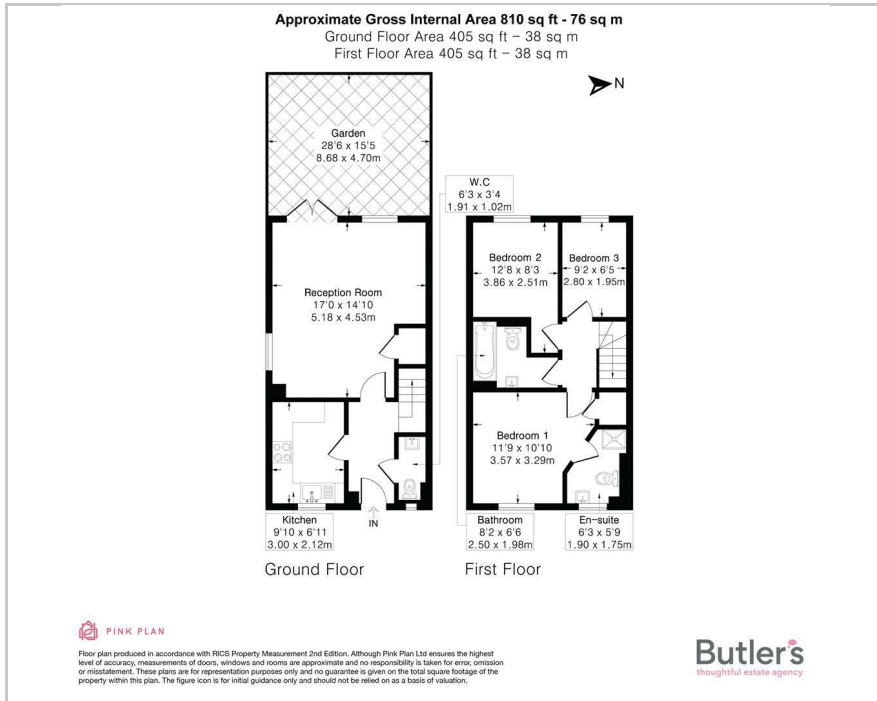

Area Map

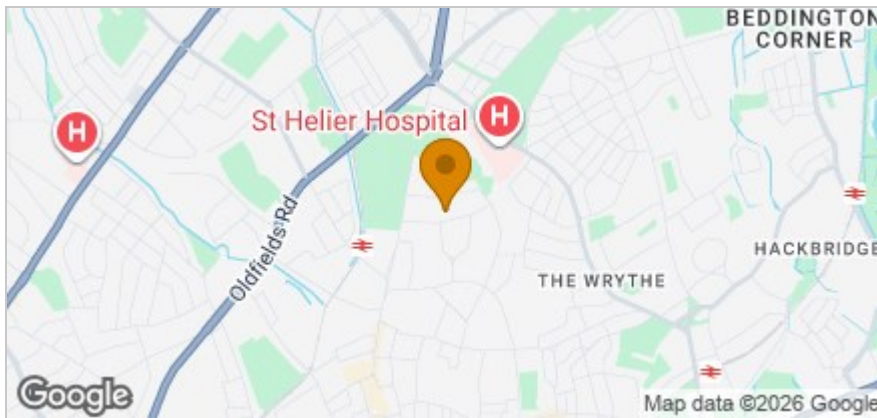

Accommodation

- Modern 3 bedroom end of terrace house
- NO ONWARD CHAIN
- Positioned in a beautiful small development in Sutton Gardens Suburb
- Rare to market and highly desirable
- Excellent order throughout
- Master bedroom with en-suite shower room
- Allocated parking next to house
- Landscaped rear garden
- Further family bathroom and ground floor W/C
- Fabulous location near great transport links, schooling and amenities

Viewing

Please contact our Butler's Sutton Office on 020 39 170 160 if you wish to arrange a viewing appointment for this property or require further information.

Energy Efficiency Graph

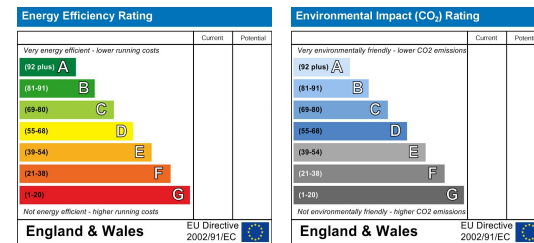

These particulars, whilst believed to be accurate are set out as a general outline only for guidance and do not constitute any part of an offer or contract. Intending purchasers should not rely on them as statements of representation of fact, but must satisfy themselves by inspection or otherwise as to their accuracy. No person in this firm's employment has the authority to make or give any representation or warranty in respect of the property.

18 Sutton Plaza, Sutton, Surrey, SM1 4FS

Tel: 020 39 170 160 Email: sutton@butlershomes.co.uk butlershomes.co.uk