

Benhill Wood Road
Sutton, SM1 3SL
Guide price £215,000



Benhill Wood Road, Sutton, SM1 3SL

Few apartments come to market that offer as much as Woodfield Court, now available at a newly reduced price of £215,000 – making it an exceptional opportunity for first-time buyers or investors alike.

The location is a standout feature. Ideally positioned near Sutton town centre, you're just moments from both Sutton Common and Sutton mainline stations, offering excellent links into London. A short bus ride takes you to Morden underground station, making commuting easy and flexible. Sutton High Street is also close by, with a wide selection of shops, cafés, and everyday amenities.

This apartment also benefits from an allocated parking space – a real advantage in this location – while landscaped communal gardens surround the building, creating a peaceful setting in a quiet area.

Inside, the apartment offers a generous layout with a bright, spacious living room – perfect for sitting back and relaxing. Large windows let in plenty of natural light and overlook the communal grounds.

There's ample built-in storage in the hallway, helping you keep everything tidy and organised without compromising on living space.

The modern kitchen has ample space to cook and dine, while the well-proportioned double bedroom provides a comfortable and restful retreat. A stylish, contemporary bathroom completes the interior – ideal for unwinding after a long day.

With its prime location, excellent layout, and new price, this apartment offers superb value. Explore the virtual tour and arrange your viewing today.



GROUND FLOOR

Hallway

Living/Dining Room
14'3 x 8'11 (4.34m x 2.72m)

Kitchen
8'4 x 7'3 (2.54m x 2.21m)

Bedroom
15'6 x 8'11 (4.72m x 2.72m)

Bathroom
6'1 x 5'10 (1.85m x 1.78m)

OUTSIDE

Allocated Parking

Communal Grounds

Area Map

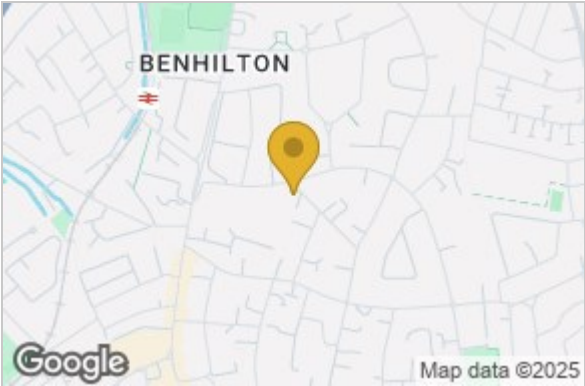

Floor Plan

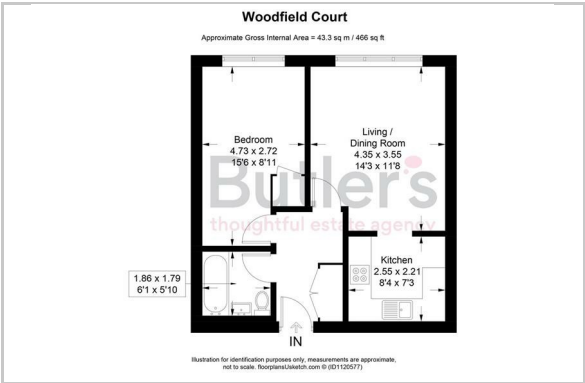

Energy Efficiency Graph

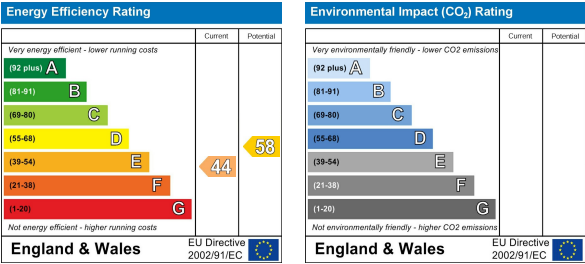

These particulars, whilst believed to be accurate are set out as a general outline only for guidance and do not constitute any part of an offer or contract. Intending purchasers should not rely on them as statements of representation of fact, but must satisfy themselves by inspection or otherwise as to their accuracy. No person in this firm's employment has the authority to make or give any representation or warranty in respect of the property.