

Butler's

thoughtful estate agency



Upland Road, Sutton, SM2 5HW
Guide price £1,000,000



Floor Plan

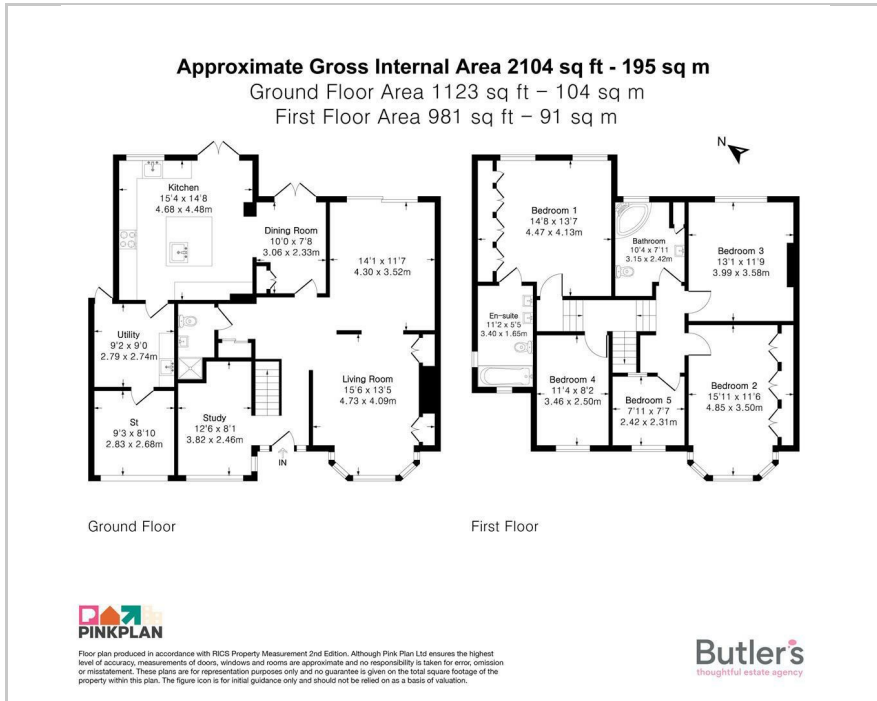

Area Map

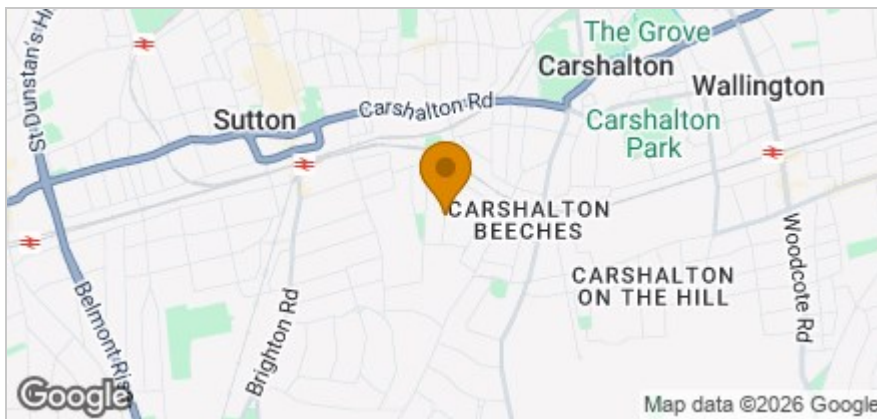

Accommodation

- GUIDE PRICE 1m - 1.1m Beautiful 5 bedroom family home
- NO ONWARD CHAIN
- Positioned within one of South Sutton's most desirable roads
- Five generous bedrooms with an en-suite and 2 further bathrooms
- 4 Spacious & versatile reception rooms
- Kitchen with adjacent utility and garage/store room
- Large rear garden with patio area for entertaining
- Front driveway providing ample parking
- Potential to extend into the loft for additional bedrooms and bathroom - subject to the relevant consents
- Close to outstanding schooling, transport links & amenities



Viewing

Please contact our Butler's Sutton Office on 020 39 170 160 if you wish to arrange a viewing appointment for this property or require further information.

Energy Efficiency Graph

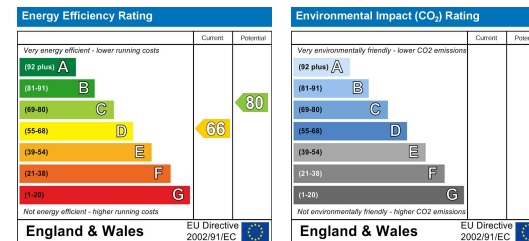

These particulars, whilst believed to be accurate are set out as a general outline only for guidance and do not constitute any part of an offer or contract. Intending purchasers should not rely on them as statements of representation of fact, but must satisfy themselves by inspection or otherwise as to their accuracy. No person in this firm's employment has the authority to make or give any representation or warranty in respect of the property.

18 Sutton Plaza, Sutton, Surrey, SM1 4FS

Tel: 020 39 170 160 Email: sutton@butlershomes.co.uk butlershomes.co.uk