

Butler's

thoughtful estate agency

Edridge Road, Croydon, CR0 1GA
Offers over £365,000



Floor Plan

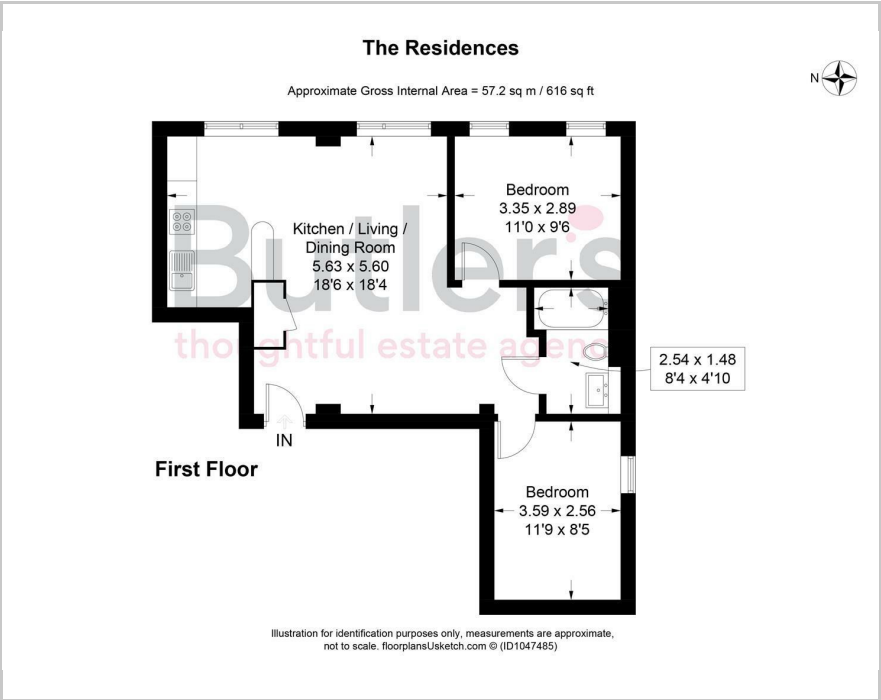

Area Map

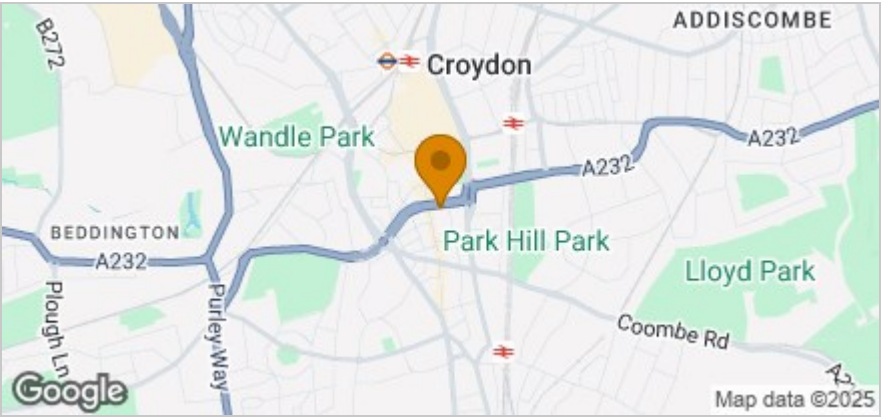

Accommodation

- Modern 2 bedroom apartment
- Excellent internal order
- Fantastic Open Plan Living Space
- On-site Concierge
- Impressive communal roof terrace
- Stylish communal lounge
- Lift to all floors
- Central location close to excellent transport links & amenities

Viewing

Please contact our Butler's Sales Office on 020 39 170 160 if you wish to arrange a viewing appointment for this property or require further information.

Energy Efficiency Graph

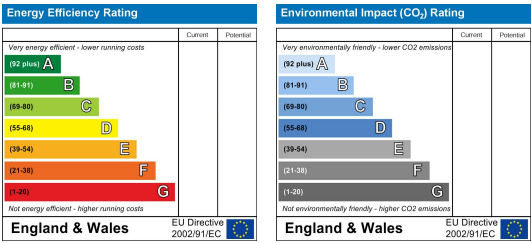

These particulars, whilst believed to be accurate are set out as a general outline only for guidance and do not constitute any part of an offer or contract. Intending purchasers should not rely on them as statements of representation of fact, but must satisfy themselves by inspection or otherwise as to their accuracy. No person in this firm's employment has the authority to make or give any representation or warranty in respect of the property.