

# Butler's

thoughtful estate agency



Carshalton Road, Sutton, SM1 4RA  
£300,000

2 1 1 B

## Floor Plan

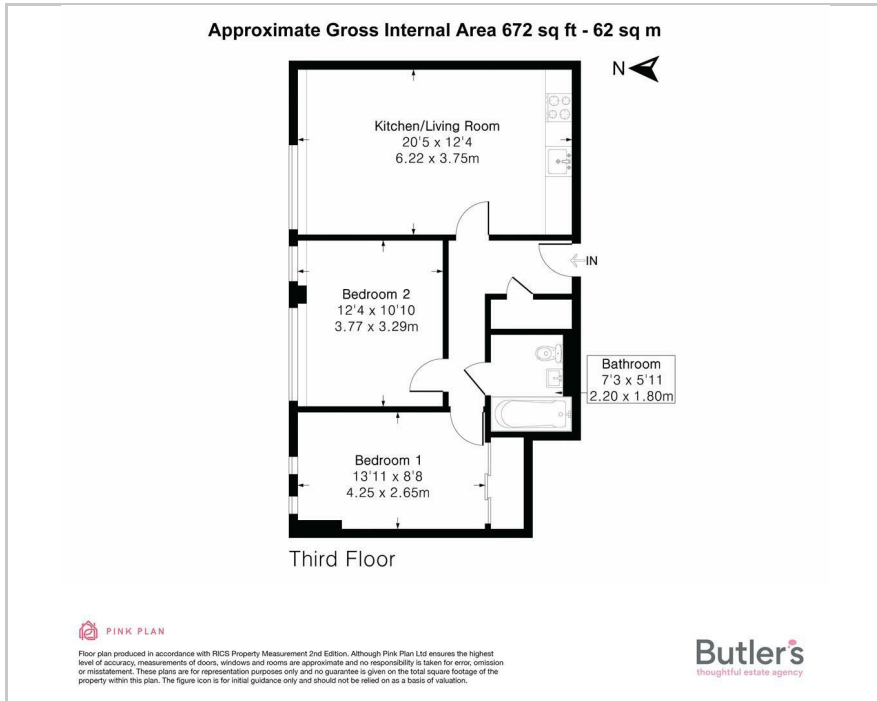

## Area Map

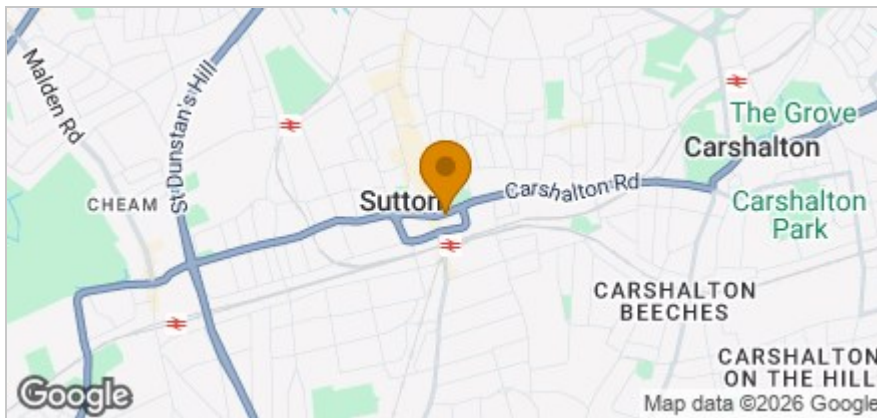

## Accommodation

- GUIDE PRICE £300,000 - £325,000
- Stunning 2 bedroom purpose built apartment
- Offered in excellent condition throughout
- Beautiful open plan kitchen/living/dining room
- Double bedrooms
- Modern kitchen & bathrooms
- Third floor, lift serviced
- Elevated High Street location, very close to Sutton mainline station
- Great access to outstanding schooling

## Viewing

Please contact our Butler's Sutton Office on 020 39 170 160 if you wish to arrange a viewing appointment for this property or require further information.

## Energy Efficiency Graph

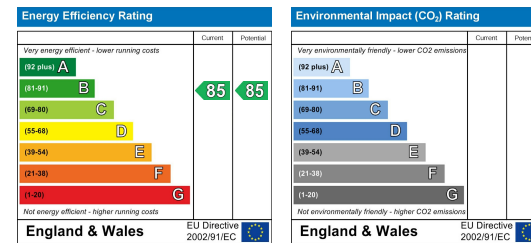

These particulars, whilst believed to be accurate are set out as a general outline only for guidance and do not constitute any part of an offer or contract. Intending purchasers should not rely on them as statements of representation of fact, but must satisfy themselves by inspection or otherwise as to their accuracy. No person in this firm's employment has the authority to make or give any representation or warranty in respect of the property.

18 Sutton Plaza, Sutton, Surrey, SM1 4FS

Tel: 020 39 170 160 Email: [sutton@butlershomes.co.uk](mailto:sutton@butlershomes.co.uk) [butlershomes.co.uk](http://butlershomes.co.uk)