

Homefield Park
Sutton, SM1 2EA
Offers in the region of £240,000



HOMEFIELD
PARK
Private
Estate
PARKING REGULATIONS APPLY

Homefield Park, Sutton, SM1 2EA

Homefield Park is one of the most coveted developments in Sutton due to the central location - with this particular apartment benefiting from a share in the freehold and having no onward chain. Inside, you'll be amazed sitting in your spacious living room that doesn't just have ample room for you to sit back and relax in, but also has ample room for you to dine, whether it be with family or friends, or even when you throw one of your dinner parties. What's more, the room has elevated views due to you being on the third floor. So, what about the rest of the property? Well you'll certainly not be disappointed with the well-proportioned kitchen that has more than enough space to cook up a storm in, also benefiting from those great outlooks when you do. When it's time to catch up on some sleep, we'll bet that you'll have an amazing nights rest in your large master bedroom that will be your own little sanctuary of style and peace. All the rooms are served by an excellent bathroom - perfect to unwind in after a long day. Outside, we've already mentioned the landscaped gardens but the property features another big bonus - an allocated parking space, which is also the case for your guests, due to an array of visitor spaces within the development. Lastly we have to mention the location. Situated so close to town, you are only a stones throw from Sutton mainline station, the high street with fabulous shopping & amenities.



THIRD FLOOR

Living/Dining Room
16'10 x 16' (5.13m x 4.88m)

Kitchen
7'8 x 6'9 (2.34m x 2.06m)

Bedroom
12' x 9'9 maximum (3.66m x 2.97m maximum)

Bathroom
8'6 x 5'2 (2.59m x 1.57m)



OUTSIDE

Allocated Parking Space

Visitors Parking

Communal Grounds

Area Map

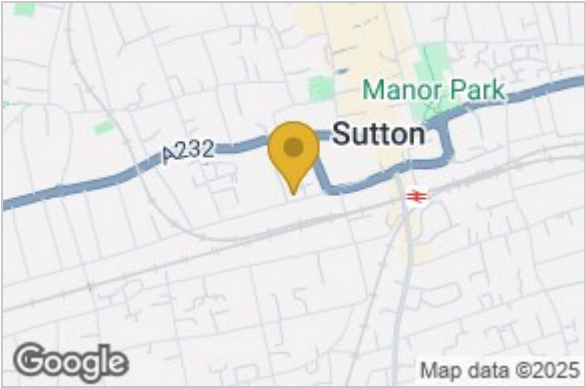

Floor Plan

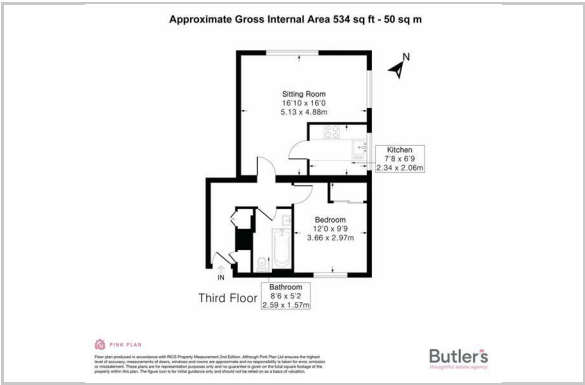

Energy Efficiency Graph

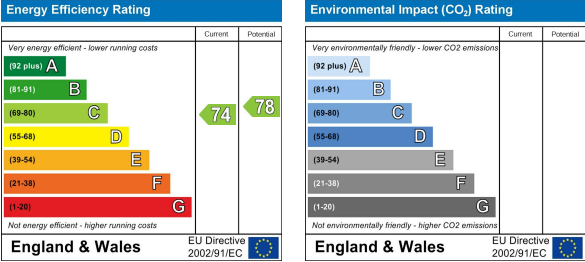

These particulars, whilst believed to be accurate are set out as a general outline only for guidance and do not constitute any part of an offer or contract. Intending purchasers should not rely on them as statements of representation of fact, but must satisfy themselves by inspection or otherwise as to their accuracy. No person in this firms employment has the authority to make or give any representation or warranty in respect of the property.