

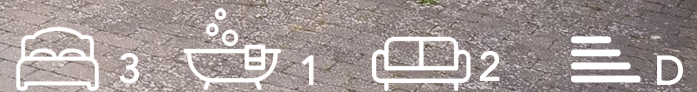

Danescourt Crescent  
Sutton, SM1 3EA  
Guide price £525,000





# Danescourt Crescent, Sutton, SM1 3EA

GUIDE PRICE £525,000 - £550,000 Nestled in an exceptionally convenient location in Sutton, this wonderful three-bedroom semi-detached home offers so much — generous space, excellent condition, and the ability to move straight in and start enjoying it immediately. Danescourt Crescent is a peaceful, non-cut-through road perfectly positioned close to excellent schools, open spaces and great transport links, making it an ideal choice for families. The high street is just a short stroll away, offering a variety of shops, cafés, and restaurants. For commuters, both Sutton Common and Sutton Mainline stations are nearby, providing quick connections into the City. Despite this superb convenience, the home offers a wonderful sense of tranquillity. Sitting on the patio overlooking your large, south-facing rear garden, you could easily forget you're so close to everything — it's the perfect spot for children to play, relax with a book, soak up the sun, or entertain friends. Inside, the versatile ground-floor layout features separate living and dining rooms, giving you the flexibility to create a dedicated workspace or host those dinner parties you've been dreaming of. The modern kitchen is beautifully designed with a breakfast bar and walk-in larder - ideal for busy family life or for anyone who loves to cook or entertain. Upstairs, there are three generous bedrooms with built in cupboards, all served by a bright family bathroom. An outhouse attached to the kitchen provides even more practicality, with a downstairs toilet, utility room, plenty of storage space, and direct garden access - perfect for bikes, buggies, or muddy boots without having to go through the house. The property also offers the scope to extend into the large loft (STPP) - as some neighbouring homes have done to create a fourth bedroom or additional living space, perfect for a growing family!



## GROUND FLOOR

Hallway

Living Room  
13' x 13' (3.96m x 3.96m)

Kitchen/Dinning Room  
20' x 9'11 (6.10m x 3.02m)

Lobby

Cloakroom  
5'5 x 2'9 (1.65m x 0.84m)

Storage Area

## FIRST FLOOR

Landing

Bedroom  
11'6 x 10'3 (3.51m x 3.12m)

Bedroom  
11'11 x 9'11 (3.63m x 3.02m)



Bedroom  
9'6 x 8' (2.90m x 2.44m)

Bathroom  
7'11 x 5'7 (2.41m x 1.70m)

OUTSIDE

Driveway

Rear Garden

## Area Map



## Floor Plan

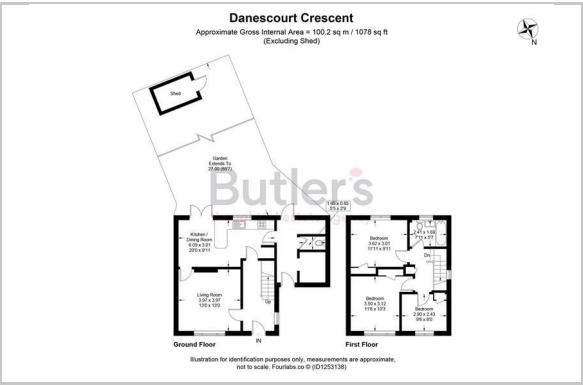

## Energy Efficiency Graph

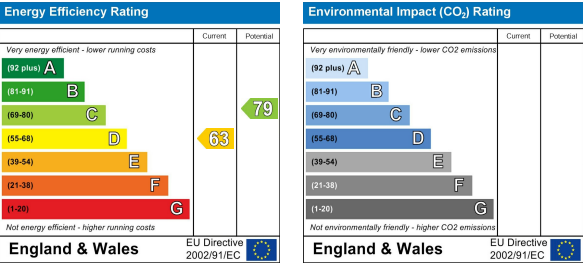

These particulars, whilst believed to be accurate are set out as a general outline only for guidance and do not constitute any part of an offer or contract. Intending purchasers should not rely on them as statements of representation of fact, but must satisfy themselves by inspection or otherwise as to their accuracy. No person in this firms employment has the authority to make or give any representation or warranty in respect of the property.