

Butler's

thoughtful estate agency



Courtenay Avenue, Sutton, SM2 5ND
Guide price £800,000

4 3 2 C

Floor Plan

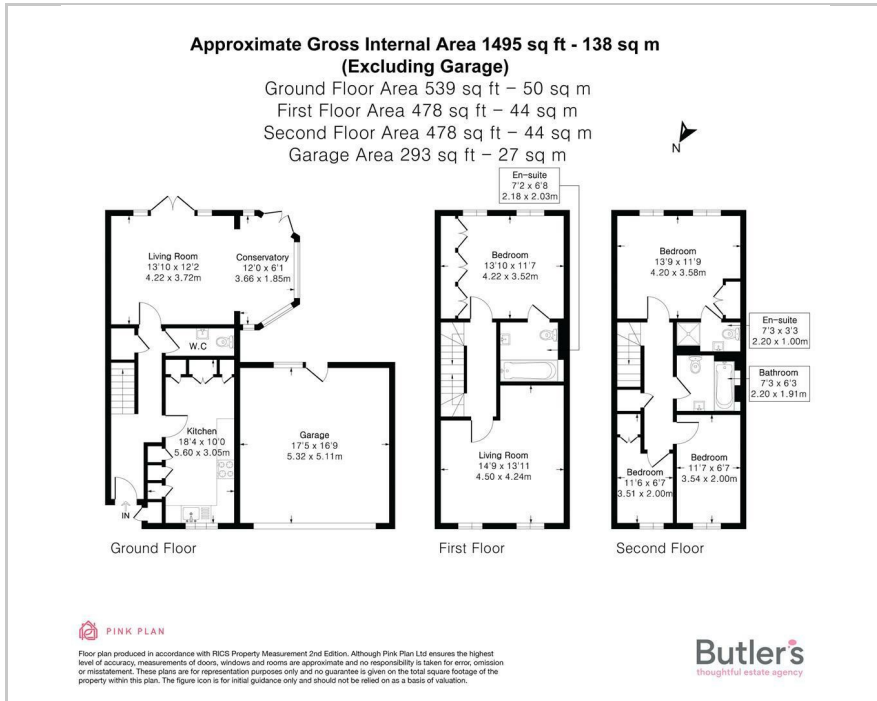

Area Map

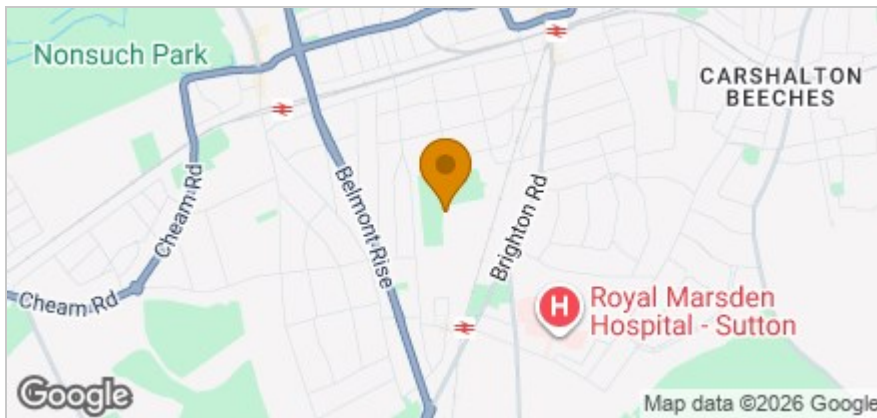

Accommodation

- Impressive 4 bedroom end-of-terrace family home
- Extremely rare to market with wonderful views over the adjacent Overton Park
- Boasting one of the largest plots on this sought after & gated estate
- Large driveway & 293 sq ft double garage with conversion/extension potential - stpp
- Wrap around landscaped garden with terrace area
- High quality refitted kitchen & bathrooms
- Principle bedrooms with en-suites, remainder with access to a family bathroom
- 2 Spacious & versatile receptions; ground floor with conservatory
- Close to outstanding schooling, transport links & amenities
- Air-conditioning to the the ground floor reception space



Viewing

Please contact our Butler's Sutton Office on 020 39 170 160 if you wish to arrange a viewing appointment for this property or require further information.

Energy Efficiency Graph

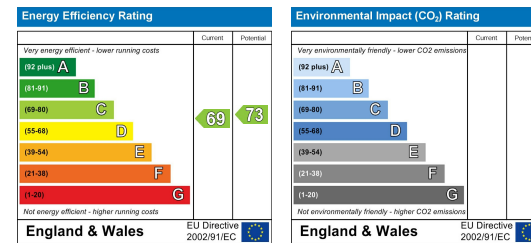

These particulars, whilst believed to be accurate are set out as a general outline only for guidance and do not constitute any part of an offer or contract. Intending purchasers should not rely on them as statements of representation of fact, but must satisfy themselves by inspection or otherwise as to their accuracy. No person in this firm's employment has the authority to make or give any representation or warranty in respect of the property.

18 Sutton Plaza, Sutton, Surrey, SM1 4FS

Tel: 020 39 170 160 Email: sutton@butlershomes.co.uk butlershomes.co.uk