

# Butler's

thoughtful estate agency

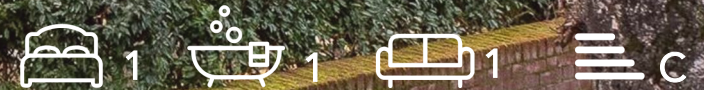

St. James Road  
Sutton, SM1 2TG  
Guide price £200,000



# St. James Road, Sutton, SM1 2TG

NO CHAIN! Positioned in one of the most exclusive roads in Sutton, this first floor converted apartment is set within a handsome period building and offered in good condition inside, having been lovingly looked after by the current owners. The great news is that there is also no onward chain, so ideal for you to move in as quickly as you can or even start earning an income if you are buying to let! So what about inside the property? Having an open plan layout, the lounge/diner has enough space to not just relax in and catch up on your favorite box set in front of the TV, but there is also space for you to entertain, with enough room for a dining table that will allow you to throw one of your famous dinner parties! Large windows also flood the room with light, accentuated through the high ceilings. The great condition continues throughout, with a modern bathroom located off the bedroom that is a sanctuary of style and peace, and a kitchen that has a good amount of workspace to cook up a storm in. Location wise, you aren't just incredibly well located next to fantastic local amenities at hand on the High Street but also have a the choice of 3 train stations close by, proving great links into the City. So what are you waiting for? Don't delay and miss out on this little gem!



## FIRST FLOOR

Open Plan Living Room/Kitchen  
15'3 x 15'1 (4.65m x 4.60m)

Bedroom  
16'5 x 7'1 (5.00m x 2.16m)

Bathroom  
8'4 x 5' (2.54m x 1.52m)

## Area Map

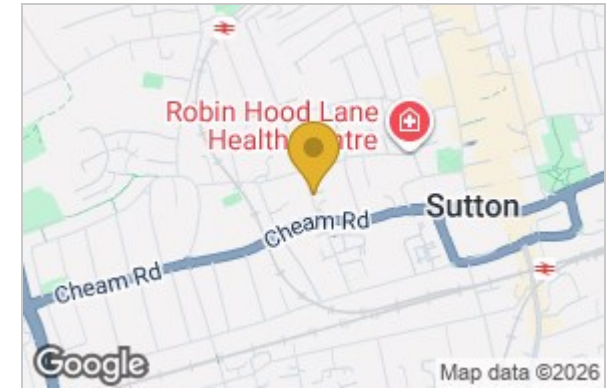

## Floor Plan

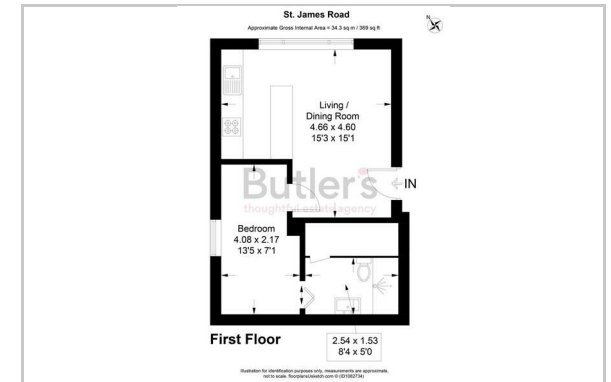

## Energy Efficiency Graph

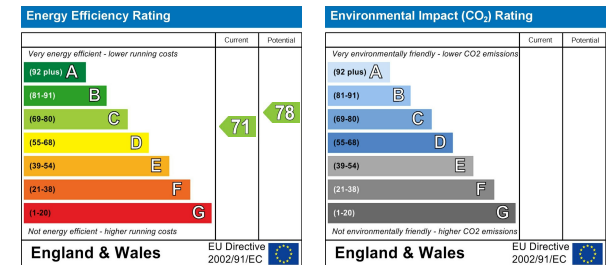

These particulars, whilst believed to be accurate are set out as a general outline only for guidance and do not constitute any part of an offer or contract. Intending purchasers should not rely on them as statements of representation of fact, but must satisfy themselves by inspection or otherwise as to their accuracy. No person in this firm's employment has the authority to make or give any representation or warranty in respect of the property.

18 Sutton Plaza, Sutton, Surrey, SM1 4FS

Tel: 020 39 170 160 Email: [sutton@butlershomes.co.uk](mailto:sutton@butlershomes.co.uk) [butlershomes.co.uk](http://butlershomes.co.uk)