

Butler's

thoughtful estate agency

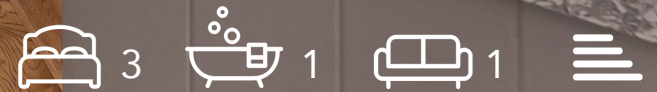

Constance Road, Sutton, SM1 4QG
Offers over £500,000



Floor Plan

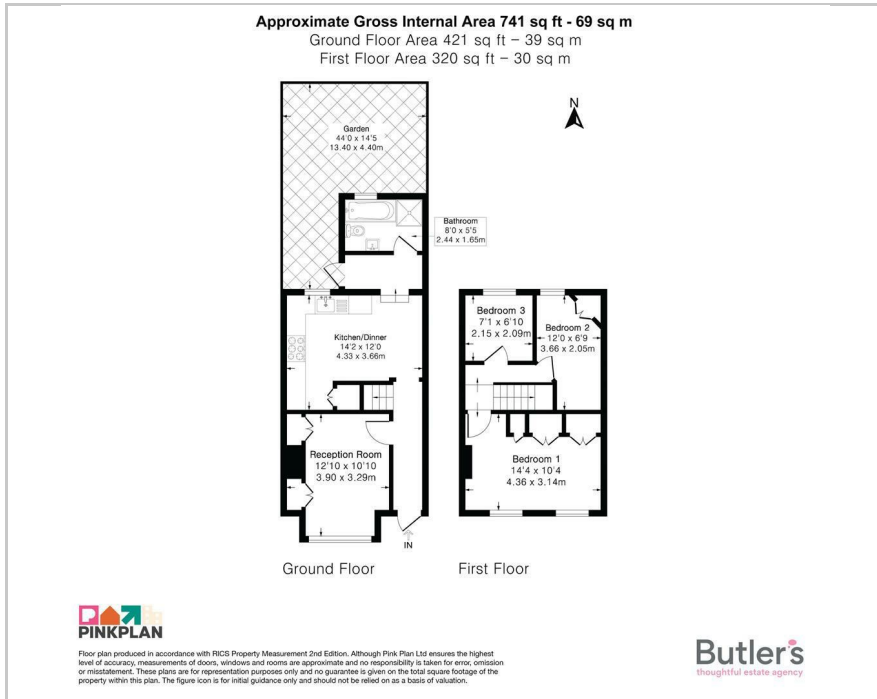

Area Map

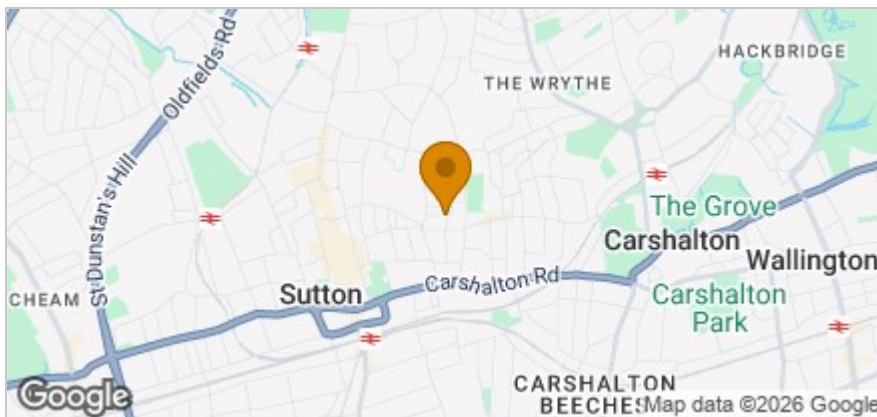

Accommodation

- Gorgeous 3 bedroom period home
- Offered in excellent condition throughout
- Spacious living room, perfect for entertaining
- Refitted kitchen/diner, finished to an excellent standard
- Landscaped rear garden
- Modern ground floor bathroom with separate bath & shower
- Central location, close to Sutton High Street
- Easy access to outstanding schooling and transport links

Viewing

Please contact our Butler's Sutton Office on 020 39 170 160 if you wish to arrange a viewing appointment for this property or require further information.

Energy Efficiency Graph



These particulars, whilst believed to be accurate are set out as a general outline only for guidance and do not constitute any part of an offer or contract. Intending purchasers should not rely on them as statements of representation of fact, but must satisfy themselves by inspection or otherwise as to their accuracy. No person in this firm's employment has the authority to make or give any representation or warranty in respect of the property.

18 Sutton Plaza, Sutton, Surrey, SM1 4FS

Tel: 020 39 170 160 Email: sutton@butlershomes.co.uk butlershomes.co.uk