

Butler's

thoughtful estate agency



Hollymoor Lane, Epsom, KT19 9BZ
Guide price £425,000



Floor Plan

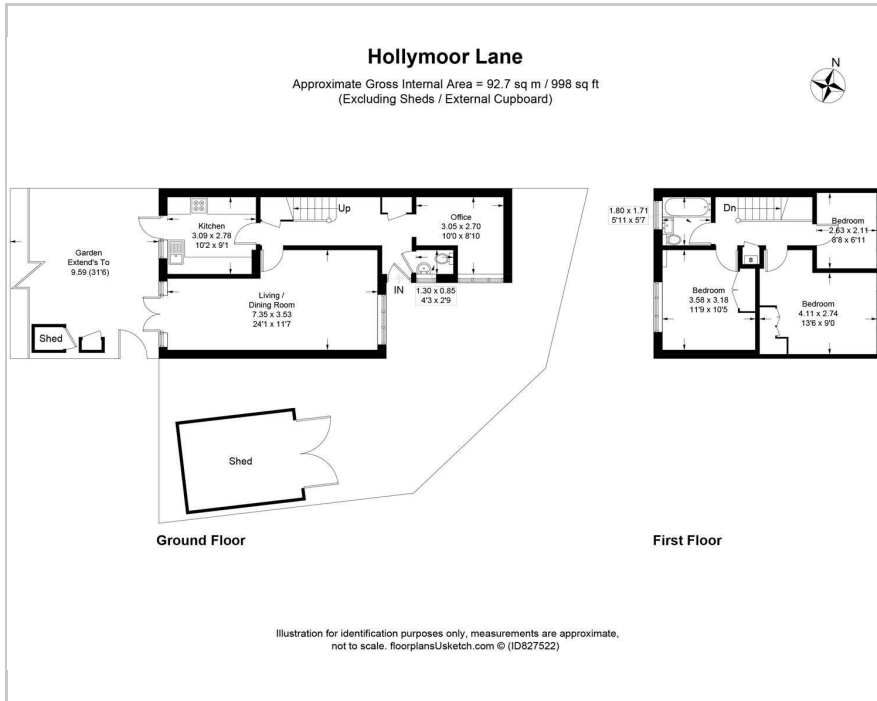

Area Map

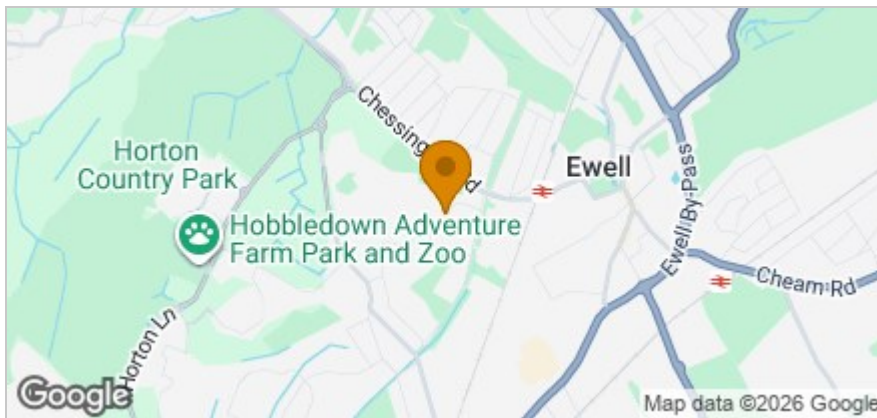

Accommodation

- GUIDE PRICE £425,000 - £450,000
- Lovely 3 bedroom end of terrace home
- Offered in good order throughout
- Large wrap-around driveway
- Level garden to rear
- Spacious living/dining room
- Additional study to front & cloakroom
- Situated extremely close to Ewell West station
- Great access to wonderful schooling & amenities



Viewing

Please contact our Butler's Worcester Park Office on 020 39 069 169 if you wish to arrange a viewing appointment for this property or require further information.

Energy Efficiency Graph

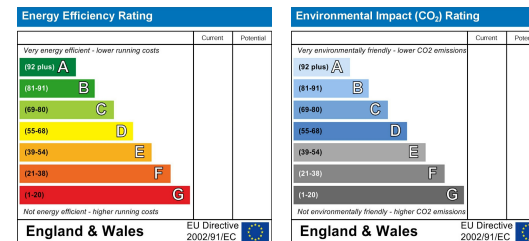

These particulars, whilst believed to be accurate are set out as a general outline only for guidance and do not constitute any part of an offer or contract. Intending purchasers should not rely on them as statements of representation of fact, but must satisfy themselves by inspection or otherwise as to their accuracy. No person in this firm's employment has the authority to make or give any representation or warranty in respect of the property.