

clever



32-34 Harwell Street

City Centre, Plymouth, PL1 5BN

Offers in excess of £800,000

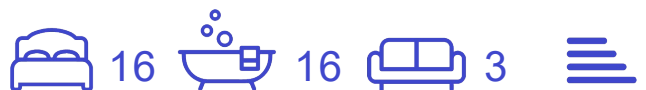

GENERATING APPROX 12.9% YIELD - £103,500 fully let - Nestled in the heart of Plymouth on Harwell Street, this impressive house presents a remarkable investment opportunity. With a generous layout featuring 16 well-appointed bedrooms and 16 bathrooms, this property is designed to accommodate a large number of residents comfortably.

The property is in excellent condition, ensuring that it is ready for immediate occupancy or rental. It currently produces a substantial income of £103,500 when fully let, making it an attractive option for investors seeking a reliable return. The prime central location offers easy access to the University & local amenities, transport links, and the vibrant culture of Plymouth, enhancing its appeal to potential students.

For those with vehicles, the property includes off-road parking for up to five cars, a valuable feature in a bustling urban area.

This end terrace house on Harwell Street is not just a home; it is a strategic investment in a thriving location. Whether you are looking to expand your property portfolio or seeking a first time investment Do not miss the chance to explore this exceptional opportunity in Plymouth.



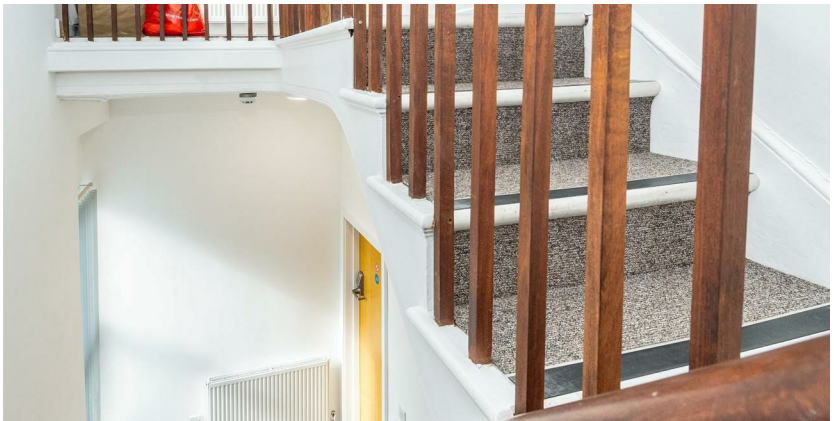

Area Map



Floor Plans

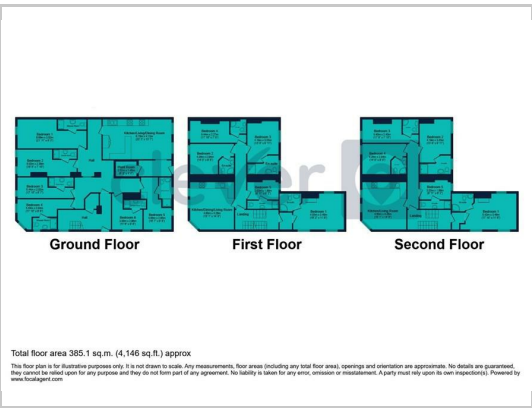

Energy Efficiency Graph

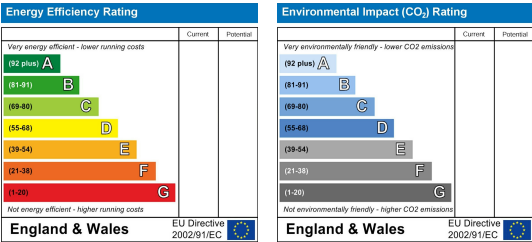

These particulars, whilst believed to be accurate are set out as a general outline only for guidance and do not constitute any part of an offer or contract. Intending purchasers should not rely on them as statements of representation of fact, but must satisfy themselves by inspection or otherwise as to their accuracy. No person in this firms employment has the authority to make or give any representation or warranty in respect of the property.

2 Old Town Street, Plymouth, PL1 1DP
 Tel: 01752421911 Email: sales@stayclever.co.uk <https://www.stayclever.co.uk>