

clever



104 Deer Park Drive

Deer Park, Plymouth, PL3 6SS

£185,000



EXCELLENT FIRST TIME BUY - Nestled in the sought-after area of Deer Park, this charming end-terrace house presents an excellent opportunity for first-time buyers. With a well-proportioned living space the property boasts two comfortable bedrooms and a welcoming large reception room, perfect for both relaxation and entertaining, as well as plenty of indoor & outdoor storage.

Constructed in 1970, this home has been maintained in good condition, ensuring a pleasant living environment. The property features a well-sized rear garden, providing a delightful outdoor space for gardening, leisure, or family gatherings.

One of the standout features of this location is its proximity to excellent school catchments, making it an ideal choice for families or those planning for the future. The combination of a desirable location, good condition, and outdoor space makes this property a rare find in today's market.

If you are looking to settle down, this end-terrace house on Deer Park Drive is a fantastic option that should not be missed.





Area Map



Floor Plans

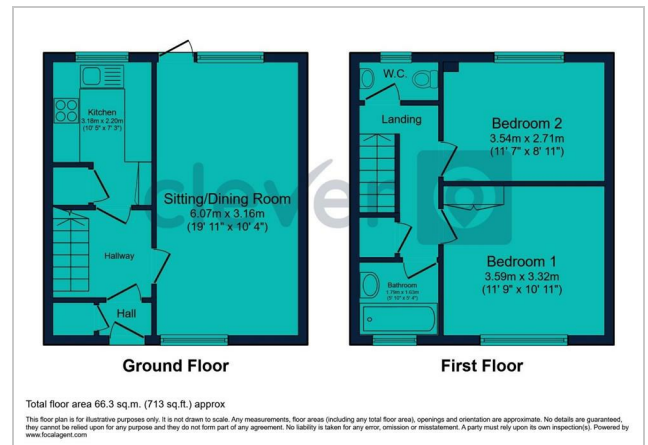

Energy Efficiency Graph

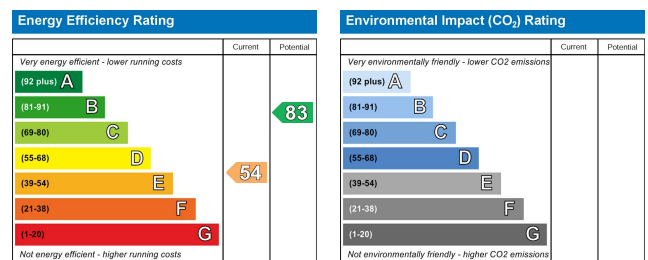

These particulars, whilst believed to be accurate are set out as a general outline only for guidance and do not constitute any part of an offer or contract. Intending purchasers should not rely on them as statements of representation of fact, but must satisfy themselves by inspection or otherwise as to their accuracy. No person in this firm's employment has the authority to make or give any representation or warranty in respect of the property.

2 Old Town Street, Plymouth, PL1 1DP

Tel: 01752421911 Email: sales@stavclever.co.uk <https://www.stavclever.co.uk>