

clever



clever 



27 Leigh Court

Eggbuckland, Plymouth, PL6 5YA

Guide price £400,000



GUIDE PRICE - £400,000 - £450,000 - Nestled in the charming area of Leigh Court, Eggbuckland, this stunning semi-detached bungalow offers a perfect blend of comfort and practicality, making it an ideal home for families or those wishing to accommodate parents. Spanning an impressive 1,410 square feet, the property boasts three well-proportioned bedrooms, two kitchens and two bathrooms, ensuring ample space for everyone.

The bungalow features two inviting reception rooms, providing versatile areas for relaxation and entertainment. The presence of two kitchens adds a unique touch, allowing for convenient meal preparation and the potential for independent living arrangements within the annexe. This thoughtful design enhances the property's appeal, catering to a variety of lifestyles.

Families will appreciate the superb local schools situated nearby, making this location particularly attractive for those with children. The surrounding area offers a welcoming community atmosphere, perfect for family life.

In summary, this exceptional bungalow in Eggbuckland is not only spacious and well-appointed but also strategically located to meet the needs of modern living. Whether you are looking to settle down with your family or create a multi-generational home, this property is sure to impress. Do not miss the opportunity to make this delightful bungalow your new home.



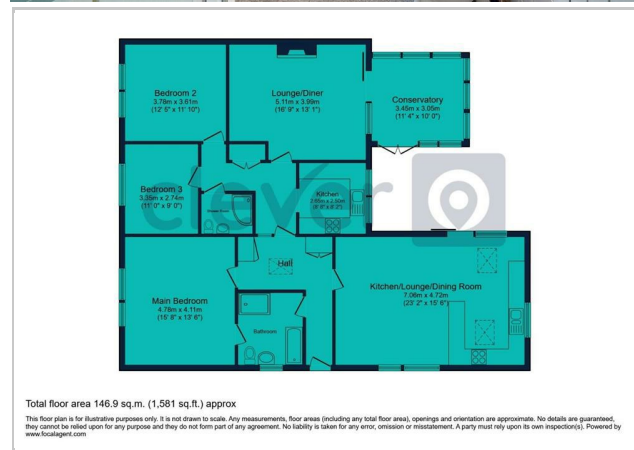
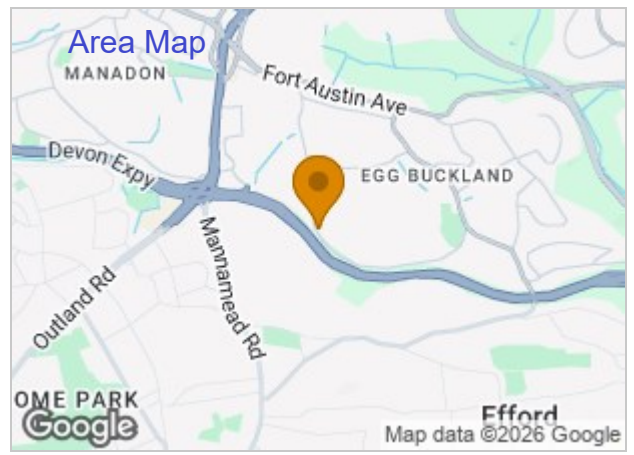

Energy Efficiency Graph

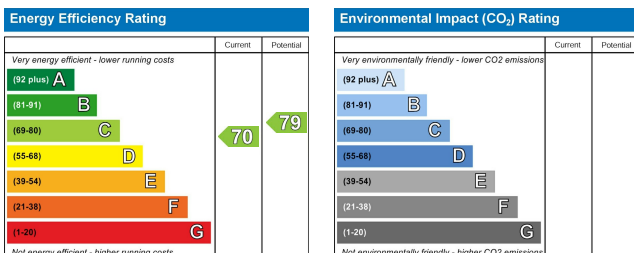

These particulars, whilst believed to be accurate are set out as a general outline only for guidance and do not constitute any part of an offer or contract. Intending purchasers should not rely on them as statements of representation of fact, but must satisfy themselves by inspection or otherwise as to their accuracy. No person in this firm's employment has the authority to make or give any representation or warranty in respect of the property.

2 Old Town Street, Plymouth, PL1 1DP
 Tel: 01752421911 Email: sales@stayclever.co.uk <https://www.stayclever.co.uk>