

# clever



## 16 Frederick Street East

Stonehouse, Plymouth, PL1 5JX

**£90,000**



Nestled in the heart of Plymouth on Frederick Street East, this charming ground floor apartment offers a perfect blend of comfort and convenience. With one well-proportioned bedroom, this property is ideal for individuals or couples seeking a cosy living space in a vibrant area.

The apartment features a welcoming reception room, providing a delightful area for relaxation or entertaining guests. The layout is thoughtfully designed to maximise space and light, creating an inviting atmosphere throughout. The bathroom is well-appointed, ensuring all your daily needs are met with ease.

One of the standout features of this property is the off-road parking, a rare find in such a central location. This added convenience allows for easy access to your vehicle while eliminating the stress of street parking.

Living in this central location means you are just a stone's throw away from a variety of local amenities, including shops, cafes, and public transport links, making it an excellent choice for those who appreciate urban living.







Area Map



Floor Plans

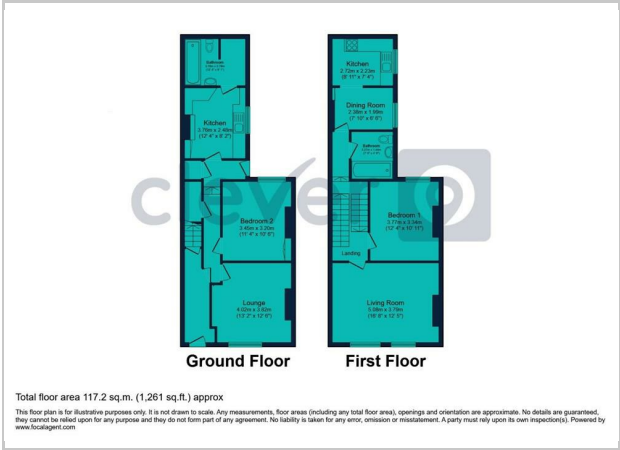

Energy Efficiency Graph

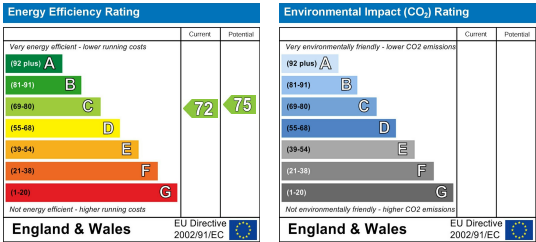

These particulars, whilst believed to be accurate are set out as a general outline only for guidance and do not constitute any part of an offer or contract. Intending purchasers should not rely on them as statements of representation of fact, but must satisfy themselves by inspection or otherwise as to their accuracy. No person in this firms employment has the authority to make or give any representation or warranty in respect of the property.

2 Old Town Street, Plymouth, PL1 1DP  
Tel: 01752421911 Email: sales@stayclever.co.uk <https://www.stayclever.co.uk>