

clever



clever 



431 Blandford Road

Efford, Plymouth, PL3 6JD

Offers in excess of £180,000



Located on Blandford Road in the popular area of Efford is this spacious semi-detached house presents an excellent opportunity for those looking to create their dream home. Spanning an impressive 861 square feet, the property boasts two spacious reception rooms, perfect for both entertaining guests and enjoying quiet family time.

The house features three well-proportioned bedrooms, providing ample space for a growing family or for those who desire extra room for guests or a home office. A conveniently located bathroom (upstairs) and a downstairs W/C add to the practicality of the layout, ensuring that the needs of modern living are met.

One of the standout features of this property is the delightful conservatory overlooking the rear garden, which invites natural light and offers a serene space to relax or enjoy a morning coffee. The private not overlooked large rear garden is a true gem, providing a wonderful outdoor area for children to play, gardening enthusiasts to flourish, or simply for enjoying the fresh air during the warmer months.

While the property is in need of modernising, this presents a fantastic opportunity for buyers to personalise and enhance the space to their taste. With a little vision and creativity, this house can be transformed into a





Area Map



Floor Plans

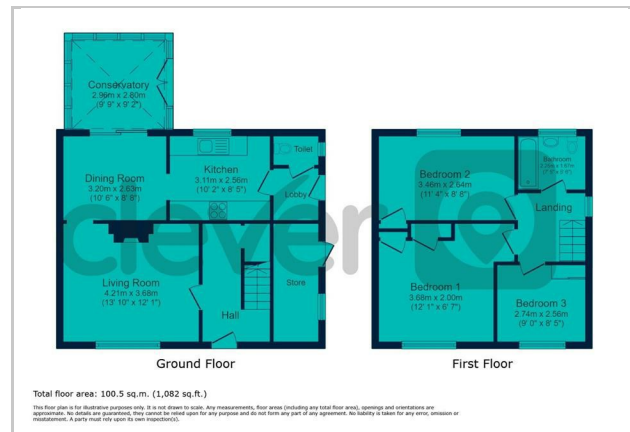

Energy Efficiency Graph

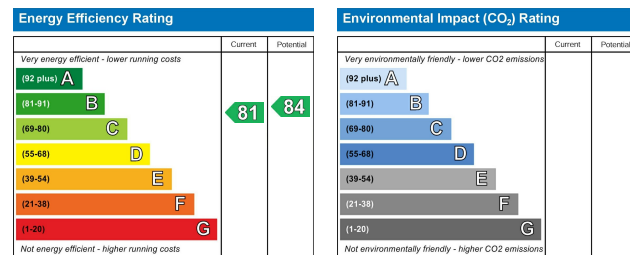

These particulars, whilst believed to be accurate are set out as a general outline only for guidance and do not constitute any part of an offer or contract. Intending purchasers should not rely on them as statements of representation of fact, but must satisfy themselves by inspection or otherwise as to their accuracy. No person in this firm's employment has the authority to make or give any representation or warranty in respect of the property.