

clever



275 Thurlestone Walk

Leigham, Plymouth, PL6 8QR

Offers in excess of £200,000



Nestled in the charming cul-de-sac of Thurlestone Walk, Plymouth, this delightful end-terrace house offers a perfect blend of comfort and convenience. Spanning an impressive 818 square feet, the property features two well-proportioned bedrooms, making it an ideal choice for small families, couples, or individuals seeking a peaceful retreat.

Upon entering, you are welcomed into a hallway leading to a spacious reception room that provides a warm and inviting atmosphere, perfect for relaxation or entertaining guests. The property also boasts a practical utility room with plumbing for a washing machine, enhancing the functionality of the home.

One of the standout features of this property is the garage located at the bottom of the rear garden, which could be an excellent work from home space. The end-terrace position ensures added privacy and a sense of space, while the cul-de-sac location offers a tranquil environment away from the hustle and bustle of city life.

Conveniently situated close to local amenities, residents will find shops, excellent schools, and recreational facilities within easy reach, making daily life effortless. The property is offered chain-free, allowing for a



Lounge/Dining Room 21'8" x 11'11" (6.61m x 3.64m)

Kitchen 8'10" x 7'9" (2.70m x 2.38m)

Bedroom 14'8" x 8'7" (4.48m x 2.63m)

Bedroom 11'3" x 9'8" (3.44m x 2.96m)



Area Map



Floor Plans

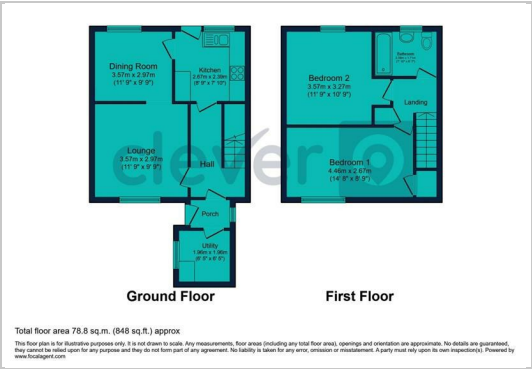

Energy Efficiency Graph

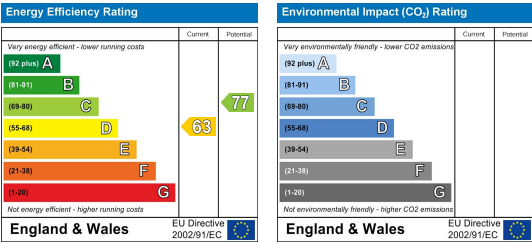

These particulars, whilst believed to be accurate are set out as a general outline only for guidance and do not constitute any part of an offer or contract. Intending purchasers should not rely on them as statements of representation of fact, but must satisfy themselves by inspection or otherwise as to their accuracy. No person in this firm's employment has the authority to make or give any representation or warranty in respect of the property.