

clever



64 Brentford Avenue

, Plymouth, PL5 4HD

£140,000



STUNNING REAR GARDEN - Nestled on Brentford Avenue in the vibrant city of Plymouth, this charming two-bedroom apartment offers a delightful blend of comfort and convenience. Spanning an impressive 764 square feet, the property boasts a spacious lounge that serves as the heart of the home, perfect for both relaxation and entertaining guests.

This apartment retains a sense of character while providing modern living. The two well-proportioned bedrooms offer ample space for rest and personalisation, making it an ideal choice for couples, small families, or individuals seeking a serene retreat. The bathroom is thoughtfully designed to cater to your daily needs.

One of the standout features of this property is the stunning rear garden, a rare find in apartment living. This outdoor space provides a tranquil escape, perfect for enjoying sunny afternoons or hosting gatherings with friends and family.

Situated in a popular location, the apartment is conveniently close to local amenities, ensuring that shops, cafes, and essential services are just a short stroll away. This prime location not only enhances the lifestyle on





Area Map



Floor Plans

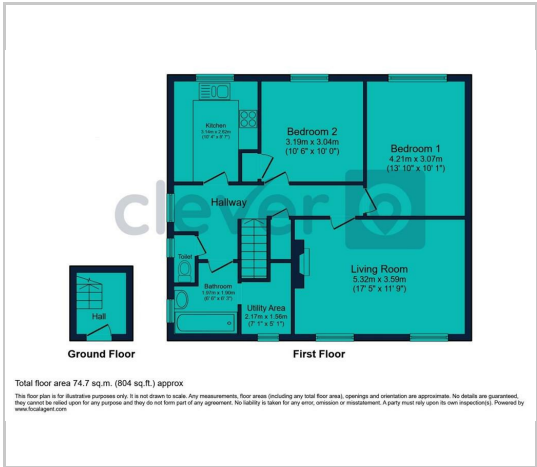

Energy Efficiency Graph

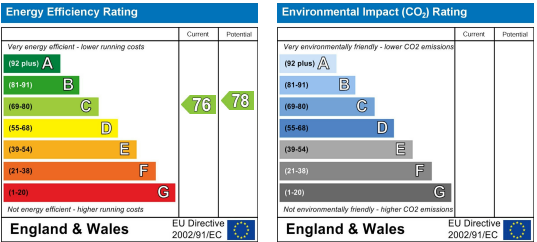

These particulars, whilst believed to be accurate are set out as a general outline only for guidance and do not constitute any part of an offer or contract. Intending purchasers should not rely on them as statements of representation of fact, but must satisfy themselves by inspection or otherwise as to their accuracy. No person in this firm's employment has the authority to make or give any representation or warranty in respect of the property.

2 Old Town Street, Plymouth, PL1 1DP
Tel: 01752421911 Email: sales@stayclever.co.uk <https://www.stayclever.co.uk>