

# clever



## 12 Glen Park Avenue

, Plymouth, PL4 6BA

**£100**



\*\* STUDENT ROOM AVAILABLE MARCH 2023 \*\*

Fantastic 4-bedroom property in ideal location, just off North Road East.

Less than a 5 minute walk to Plymouth University and Mutley Plain, this property boasts all equal and good size double bedrooms!

Room 1: LET

Room 2: £100

Room 3: LET

Room 4: LET



## Area Map



## Floor Plans

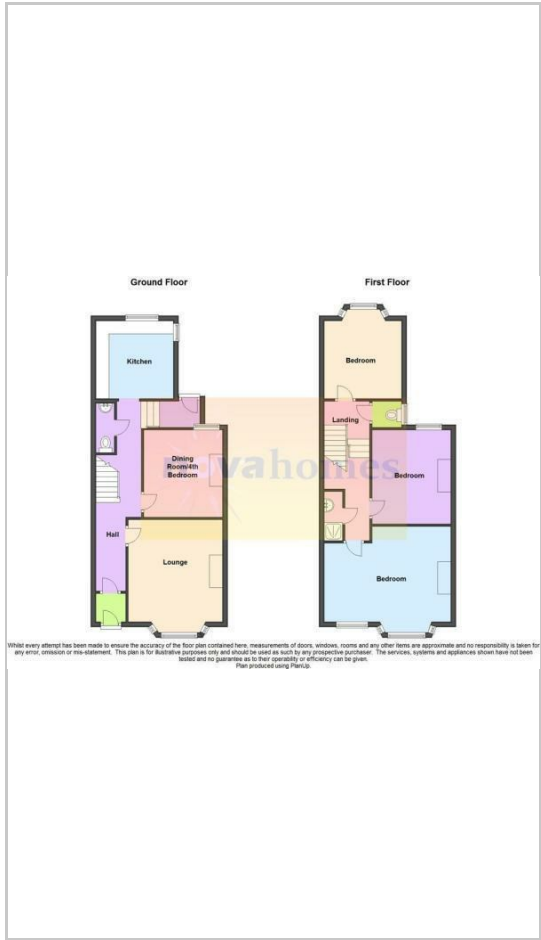

## Energy Efficiency Graph

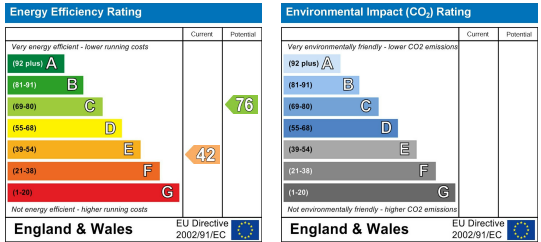

These particulars, whilst believed to be accurate are set out as a general outline only for guidance and do not constitute any part of an offer or contract. Intending purchasers should not rely on them as statements of representation of fact, but must satisfy themselves by inspection or otherwise as to their accuracy. No person in this firm's employment has the authority to make or give any representation or warranty in respect of the property.

Queen Anne Terrace, 2 Plymouth, Devon, PL4 8EG  
 Tel: 01752500511 Email: hello@stayclever.co.uk <https://www.stayclever.co.uk>