



TO LET

Garrison Close, Hounslow, TW4 5EZ
£1,795 Per Calendar Month

DBK
ESTATE AGENTS

- Available To Rent Immediately!
- Two Bedrooms
- Fitted Kitchen
- Rear Garden
- Hounslow Overground Station 0.9 Miles
- Terraced House
- Reception Room
- Stylish Family Bathroom Suite
- Front Garden with Off Street Parking
- Hounslow Central Station within 0.9 miles

THE PROPERTY

A fashionable terrace family home completed with a modern interior throughout and Available To Rent Immediately!

Currently the property is arranged over two floors and sprawls circa 601 sq.ft with two bedrooms, a well-proportioned reception room, a fitted kitchen featuring some integrated appliances and a chic family bathroom suite.

To the outside is a rear garden benefitting from a lawn and a patio area and a front garden offering off street parking,

Being situated nearby to Staines Road (TW4) the property is not short of amenities. Very close to family parks and Hounslow Heath Nature Reserve. Walkable distance to *Outstanding* Heathland Secondary School and Hounslow-Heath/Orchard Primary School.

Easy transport links into Central London via Overground & Underground Stations which are both less than a mile away. Walkable distance to bus stops on Staines/Hanworth/Wellington roads into Hounslow Town Centre and London Heathrow Airport.

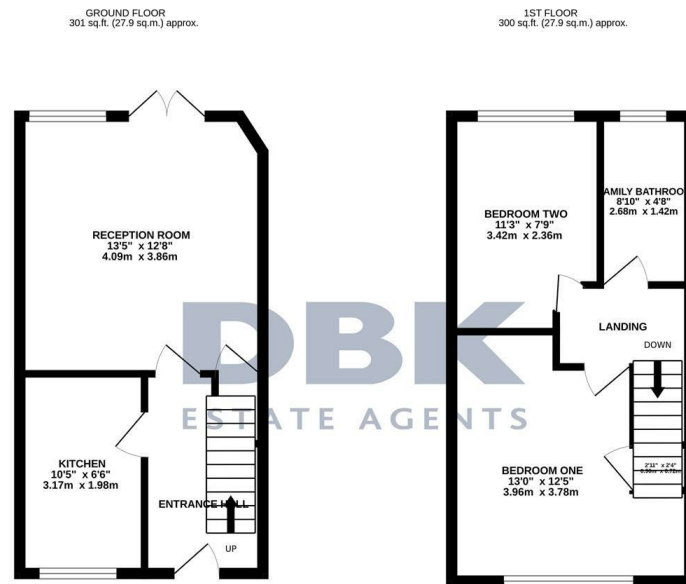

TOTAL FLOOR AREA: 601 sq.ft. (55.8 sq.m.) approx.

Whilst every attempt has been made to ensure the accuracy of the description contained herein, measurements of floors, windows, rooms and any other items are approximate and no responsibility is taken for any error, omission or mis-statement. This plan is for illustrative purposes only and should be used as such by any prospective purchaser. The services, systems and appliances shown have not been tested and no guarantee as to their operability or efficiency can be given.
Made with Metropax ©2024