



TO LET

Lichfield Road, Hounslow, TW4 6HS
£1,550 Per Calendar Month

DBK
ESTATE AGENTS

- Available To Rent End of Februaury!
- Modern + Fashionable Interior
- Reception Room
- Large Rear Garden
- Hounslow West Underground Station 0.7 miles
- First Floor Maisonette
- Two Double Bedrooms
- Large Kitchen
- Off Street Parking
- Cranford Primary School 0.7 miles

THE PROPERTY

Available To Rent End of Februaury!

A fashionable first floor maisonette offering larger than average accommodation spread over circa 850 sq.ft with two double bedrooms, reception room, modern kitchen and a chic bathroom suite. Supplementary to this is a large rear garden with two storage sheds and front garden for off street parking.

Conveniently sited within a short walk to the buzzing Hounslow West Bath Road this property does not lack amenities. Reputable schools such as Hounslow Heath Infant and Nursery School and The Heathland School both scoring OUTSTANDING by OFSTED lay close by. There are also transport links to London Heathrow Airport, Central London via Hounslow West Underground Station & Hatton Cross Underground Station.

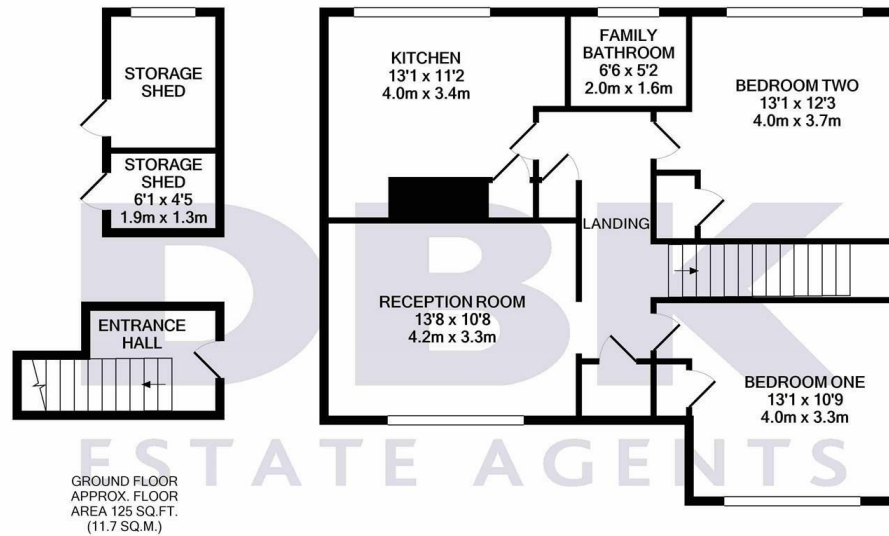

1ST FLOOR
APPROX. FLOOR
AREA 710 SQ.FT.
(65.9 SQ.M.)

TOTAL APPROX. FLOOR AREA 835 SQ.FT. (77.6 SQ.M.)

Whilst every attempt has been made to ensure the accuracy of the floor plan contained here, measurements of doors, windows, rooms and any other items are approximate and no responsibility is taken for any error, omission, or mis-statement. This plan is for illustrative purposes only and should be used as such by any prospective purchaser. The services, systems and appliances shown have not been tested and no guarantee as to their operability or efficiency can be given

Made with Metroptix ©2020