



# TO LET

**Highfield Road, Feltham, TW13 4GR**  
**£1,400 Per Calendar Month**

**DBK**  
ESTATE AGENTS

- Available To Rent End of May!
- One Double Bedroom
- Large Reception Room/ Diner
- Fitted Wardobes
- Prime Location
- Third Floor Apartment
- Modern Fitted Kitchen
- Family Bathroom/ WC
- Secure Entry System
- Feltham Station 0.3 miles

THIRD FLOOR  
429 sq.ft. (39.8 sq.m.) approx.

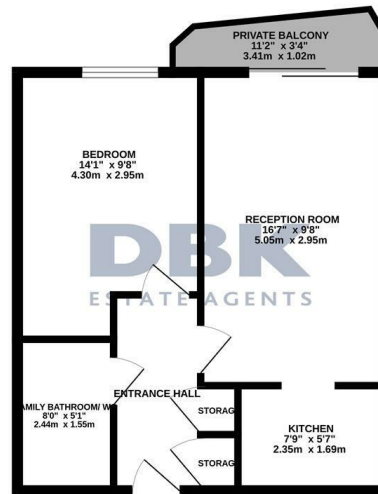

TOTAL FLOOR AREA: 429 sq.ft. (39.8 sq.m.) approx.

While every attempt has been made to ensure the accuracy of the figures contained here, measurements of floors, windows, doors and any other items are approximate and to be interpreted as being for guide only. No liability is accepted for any errors or omissions. The plan is for illustrative purposes only and should be used as a guide for prospective purchasers. The services, systems and appliances shown have not been tested and no guarantee is given as to their operability or efficiency can be given.  
Made with Metropack 12/02/11

## THE PROPERTY

Available To Rent End of May!

A fabulous third floor apartment located within the heart of Feltham, sprawling circa 452 sq.ft. The property consists of a double bedroom, a large reception room/ diner, a modern fitted kitchen and a family bathroom suite. Complementary to this is a private balcony, ample storage and a secure entry system.

Conveniently located just High Street, Feltham the property falls within an ample array of nearby well-regarded amenities including supermarkets, Cineworld Cinema and local restaurants/ bars. For transport, just minutes a walk is Feltham BR Station and for those commuting by vehicle the A30 and A316 can be found within a short drive. Reputable schools such as Cardinal Road Infant and Nursery School and Reach Academy Feltham both scoring OUTSTANDING by OFSTED can be found within 0.5 miles of the property.