



TO LET

Parkfield Parade, Feltham, TW13 4HJ
£1,175 Per Calendar Month

DBK
ESTATE AGENTS

- Available To Rent Mid June 2021
- First Floor Apartment
- Two Spacious Bedrooms with Fitted Wardrobes
- Large Reception Room
- Well Proportioned Kitchen/ Diner
- Family Bathroom/ WC
- Hallway/ Utility Room
- Gas Central Heating
- Walking Distance to Feltham High Street
- Feltham Station 0.6 miles

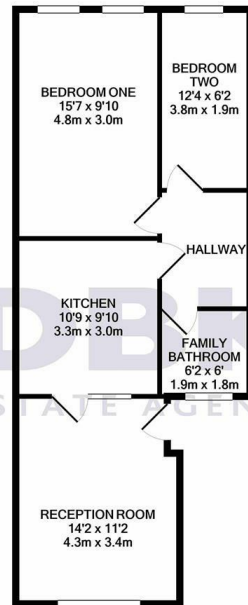

TOTAL APPROX. FLOOR AREA 576 SQ.FT. (53.5 SQ.M.)

Whilst every attempt has been made to ensure the accuracy of the floor plan contained here, measurements of doors, windows, rooms and any other items are approximate and no responsibility is taken for any error, omission, or mis-statement. This plan is for illustrative purposes only and should be used as such by any prospective purchaser. The services, systems and appliances shown have not been tested and no guarantee as to their operability or efficiency can be given.
Made with Metropix ©2020

THE PROPERTY

A modern first floor apartment AVAILABLE TO RENT IMMEDIATELY!

The accommodation comprises of two bedrooms complete with fitted wardrobes, large reception room, spacious fitted kitchen/dining area and a family bathroom/WC. Supplementary to this is a hallway/ utility room, gas central heating and double glazed windows. .

Sited moments away from Local amenities and excellent nearby transport links such as Feltham Overground Station; connecting commuters to The City as well as local bus links providing transport to neighbouring towns and Heathrow Airport. Reputable schools such as Reach Academy and Feltham Hill Infant and Nursery School very accessible.