



TO LET

Hounslow Road, Feltham, TW14 0AU
£2,200 Per Calendar Month

DBK
ESTATE AGENTS

- Available To Rent Immediately!
- Semi-detached House
- Three Sizeable Bedrooms
- Two Reception Rooms
- Modern Fitted Kitchen
- Chic Family Bathroom/ WC + Separate WC
- Large Rear Garden
- Off-street Parking Available
- Sparrow Farm Junior School 0.2 miles
- Feltham Station 0.4 miles

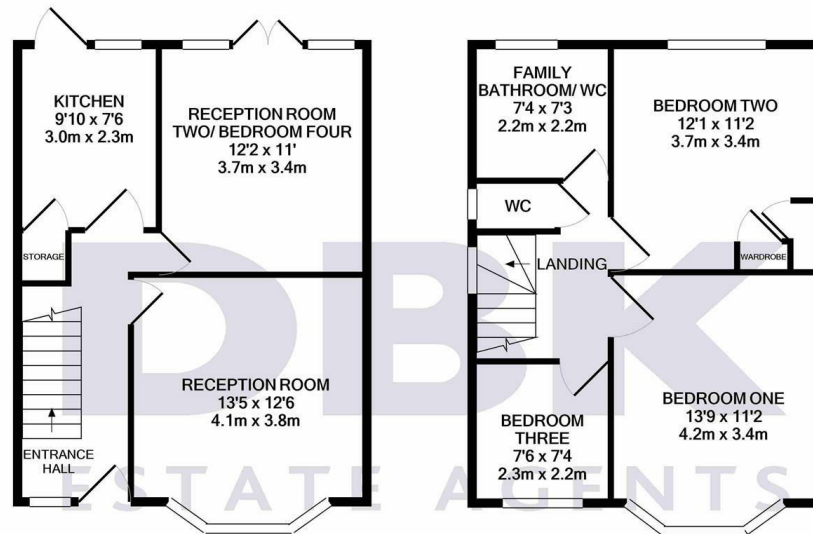

GROUND FLOOR
APPROX. FLOOR
AREA 458 SQ.FT.
(42.5 SQ.M.)

1ST FLOOR
APPROX. FLOOR
AREA 459 SQ.FT.
(42.7 SQ.M.)

TOTAL APPROX. FLOOR AREA 917 SQ.FT. (85.2 SQ.M.)

Whilst every attempt has been made to ensure the accuracy of the floor plan contained here, measurements of doors, windows, rooms and any other items are approximate and no responsibility is taken for any error, omission, or mis-statement. This plan is for illustrative purposes only and should be used as such by any prospective purchaser. The services, systems and appliances shown have not been tested and no guarantee as to their operability or efficiency can be given

Made with Metropix ©2021

THE PROPERTY

Available To Rent Immediately!

This attractive three-bedroom semi-detached home offers generous living space, modern interiors, and a highly convenient location. Thoughtfully designed for comfort and practicality, the property features two well-proportioned reception rooms, ideal for both family living and entertaining.

A modern fitted kitchen provides a stylish and functional space for cooking, while the contemporary family bathroom/WC plus an additional separate WC ensure everyday convenience.

To the rear, a large private garden offers ample room for outdoor enjoyment, making it perfect for families or those who love to entertain. The property also benefits from off-street parking, adding to its overall ease of living.

Sited on the popular Hounslow Road connecting you an ample array of local amenities as well as local reputable schools including Sparrow Farm Infant, Nursery and Junior Schools. Conveniently located close to London Heathrow Airport and a wealth of transport links including the A312/ A30/ A4/ M4 and M25 connecting you to The City and neighbouring towns.